

Smoothie blender

**orava**

# RMU-40A

Instruction manual

EN



CE

RMU-40A

# Intended use of the device

The device is designed exclusively for mixing liquid, soft and semi-hard foods as fruit to the extent specified by technical and operational parameters and functions, safety and user instructions and external influences of the operating environment.

ORAVA electrical appliances are manufactured in accordance with the state of the art and recognized safety regulations. Nevertheless, incorrect and unprofessional use or use contrary to the intended purpose may create a risk of injury or endanger the life of the user or a third party, resp. damage to equipment and other property.

## 1. GENERAL SAFETY INSTRUCTIONS AND WARNINGS



### **Read all instructions before using the device!**

- This document contains important safety instructions and warnings for the safe, correct and economical operation of electrical equipment. Adherence to it helps the user to avoid risks, increase the reliability and durability of the product.
- In this document, the general term product is used in the text sections as: electrical equipment - is any equipment used for the production, conversion, transmission, distribution or use of electricity.
- In terms of the purpose of the use of electricity, the term electrical equipment in the narrower sense will include the following categories:
  - electrical household appliances,
  - information and communication equipment,
  - consumer electronics,
  - lighting equipment,
  - electrical and electronic tools,
  - toys and equipment for sports and recreational purposes,
  - medical devices (aids),
  - monitoring and control devices,
  - vending machines.

### **1.1 General safety instructions**

- Before putting the device into operation, we recommend that you carefully read the operating instructions and operate the device according to the specified instructions!
- The safety instructions and warnings in this manual do not cover all possible conditions and situations that may occur when using the device. The user must understand that personal responsibility and care are factors that cannot be incorporated into any of the products. These factors must therefore be ensured by the users operating the equipment.
- By failing to observe the safety instructions and warnings, the manufacturer is not liable for any damage to health or property!
- If possible, keep the operating instructions close to the device throughout its service life. Always keep the operating instructions with the appliance for future reference and use by new users.

- Use the device only for the intended purpose and in the manner specified by the manufacturer.
- The device is intended for use in the home and in similar indoor areas intended for housing without special focus.
- In addition to domestic use, this appliance is also intended for the following uses:
  - in shops, offices and other similar work environments;
  - in farm buildings;
  - in hotels, motels and other residential areas;
  - in bed and breakfast establishments.
- This is not a professional device for commercial use.
- Do not alter the technical parameters and characteristics of the device by unauthorized modification or modification of any part of the device.
- The manufacturer is not liable for damage caused during transport, incorrect use, damage or destruction of the device due to adverse weather conditions.

## **1.2 Safety of the operating environment**

- Do not use the device in an industrial or outdoor environment!
- Do not expose the device to:
  - sources of excessive heat or open flame,
  - dripping or splashing water,
  - vibration and excessive mechanical stress,
  - insects, animals and flora,
  - aggressive and chemical substances.
- The operating environment of the device must always comply with the specified basic characteristics.
- Characteristics of the operating environment:
  1. Ambient temperature:  $+5 \div +40$  ° C
  2. Humidity:  $5 \div 85\%$
  3. Altitude:  $\leq 2,000$  m
  4. Occurrence of water: occasional condensation of water or occurrence of water vapor
  5. Occurrence of foreign bodies: the amount and type of dust are insignificant
  6. Degree of protection by cover: min. IP20 (device is protected against touch dangerous parts with a finger and unprotected against the effects of water)
- This degree of protection by the cover is not marked on the product and in the technical parameters stated in the operating instructions.
- If the degree of protection of the cover on the product is different from the degree of IPX0, this information is then stated on the rating label of the device or in the technical parameters of the operating instructions.
- Other characteristics of the operating environment in the household (mechanical stress - shocks and vibrations, occurrence of vegetation, animals, weather conditions ...) are negligible in terms of the effect on the correct and safe use of electrical equipment.

### 1.3 Electrical safety

- Before connecting the appliance to the mains for the first time, make sure that the mains voltage indicated on the type plate of the appliance corresponds to the mains voltage in your home.
- The electrical appliance is designed to be supplied from the mains 1 / N / PE ~ 230 V 50 Hz.
- The electrical safety of the appliance is only guaranteed if it is connected correctly to the mains.
- Electrical equipment of protection class I is equipped with protection against electric shock by means of protective earthing of inanimate parts, which can become dangerously alive in the event of equipment failure. Always connect such devices to properly installed power outlets that are equipped with a protective earth and have a properly connected protective earth conductor. These are all electrical devices equipped with a three-wire power supply.
- Electrical equipment of protection class II is equipped with protection against electric shock by double insulation or reinforced insulation dangerous live electrical parts. Protection class II equipment must not be equipped with means for connecting a protective earth. These are all electrical devices equipped with a two-wire power supply.
- Electrical protection class III devices are devices that are powered by a source of low safe voltage (battery or accumulator) and do not pose any danger to the user in the event of an electric shock.
- To ensure increased safety against the risk of electric shock when using electrical appliances by laymen, it is recommended to install a residual current device (RCD) with a rated tripping current not exceeding 30 mA in the power supply circuit for sockets with a rated current not exceeding 20 A. Consult a qualified electrician to ensure the safety and correctness of the electrical installation.
- Use only the power cord with the plug (mains lead) that came with the device and is compatible with the mains socket. Use of another cable may result in fire or electric shock.
- Always connect the appliance to an easily accessible mains socket. In the event of an operating fault, the appliance must be switched off and disconnected from the mains as soon as possible.
- The power cord and mains plug must always remain easily accessible for safe disconnection of the electrical appliance from the mains.
- Do not unplug the power cord / power cord by pulling on the cord / cord. Disconnect by unplugging the power cord by the power cord / power cord.
- If you use an extension cord, make sure that the total ampere rating of all devices plugged into the extension cord does not exceed the extension cord's ampere rating.
- If you must use an extension cord or power supply, make sure that the extension cord or power supply is connected to an electrical outlet and not to another extension cord or power supply. The extension cord or power strip must be rated for grounded electrical plugs and plugged into a properly grounded electrical outlet.
- The plug of the appliance's power cord must be compatible with the mains socket. Never use any adapters or modify the outlet in any other way. Do not use unsuitable and damaged sockets!

- To prevent electric shock, plug the device's power cords into properly grounded electrical outlets. If the device is equipped 3-pin plug, do not use adapters that do not have a grounding element or remove the grounding element from the plug or adapter.
- Do not bend, squeeze or otherwise expose the appliance's power cord / mains cord to mechanical stress or external heat sources. Damage to the power cord may result in electric shock.
- If the power cord is damaged, unplug the appliance and do not continue to use it.
- If the supply cord / plug is damaged, it must be replaced by the manufacturer, its service agent or similarly qualified persons in order to avoid a hazard.
- Regularly check and keep the electrical appliance as well as the power cord and mains socket. Unplug the power cord regularly and clean as needed. Contamination by dust or other substances can cause damage to the insulation condition and subsequent fire.
- Do not expose the electrical appliance to water or humid environments. Water entering the appliance increases the risk of electric shock. If the power cord is wet or water has entered the appliance, unplug it immediately. If the appliance is connected to the mains and if possible, switch off the power supply to the circuit breaker before attempting to disconnect the power supply. Be extremely careful when unplugging wet cables from a live power source.
- If the protective covers are removed during the installation (connection) of the electrical equipment, its electrical parts must not be accessible to the user after the installation.

#### **1.4 Personal safety**

- This appliance is intended for use and operation by persons without electrical qualification - by laymen, according to the instructions provided by the manufacturer.
- Operations of the equipment include activities such as turning the equipment on and off, user manipulation and setting of operating parameters, visual or auditory inspection of the equipment, and user cleaning and maintenance.
- This appliance is intended for use by children from 8 years of age and persons with reduced physical, sensory or mental capabilities, or experience or knowledge if they have been supervised or instructed in the safe use of the appliance and have understood the dangers involved.
- Children must not play with the appliance.
- Cleaning and maintenance by users must not be performed by children without supervision.
- Always keep the appliance out of the reach of children during use and operation. Remember that the appliance can also be downloaded with a freely accessible mains cord.
- Always take extra care when operating the appliance! Do not use an electrical appliance if you are excessively tired, under the influence of drugs that reduce attention and concentration.
- Careless handling can lead to serious injuries.
- The device is not a toy. Keep it out of the reach of children under the age of 8 and people with reduced physical, sensory or mental capabilities.
- Children should be supervised to ensure that they do not play with the appliance.

## 1.5 Cleaning, maintenance and repairs

- Carry out routine user cleaning and maintenance of the electrical appliance only as recommended. Do not use solvents or harsh cleaning items for cleaning. Dirt and visible stains from finger contact, resp. hands can be cleaned using cleaning detergents specially designed for cleaning household appliances.
- Always disconnect the appliance from the mains when you are not using it, cleaning it or when the appliance has malfunctioned.
- Protect electrical appliances that are cleaned after use and are not intended for complete or partial immersion in water or any other liquid against the effects of dripping and / or splashing water and against immersion.
- Electrical household appliances, like all other technical equipment, are subject to the effects of the surrounding operating environment and natural wear. Due to the fact that there is no legal framework for regular maintenance used in household appliances, the manufacturer recommends that the user have the appliance inspected and professionally cleaned at least once a year by a professional service.
- By doing so, it is possible to maintain safety, operational reliability and increase the service life of the equipment.
- Do not disassemble the electrical appliance! The appliance operates with dangerous voltage. Therefore, always switch off the appliance and disconnect it from the mains during user maintenance. In the event of a fault, have it repaired by an authorized service center.
- Before you call for service:
  1. Switch the appliance off and on to make sure that the fault reappears.
  2. If the appliance malfunctions persist after the above operations, call the nearest specialist garage.
- Never repair the electrical appliance yourself!
- Unauthorized, unqualified and unprofessional intervention in the electrical appliance may result in electric shock or other serious injury.
- Only entrust warranty or post-warranty repair of the electrical appliance to a qualified technician (\*).

(\*) Qualified specialist: the sales department of the manufacturer or importer or a person who is qualified and authorized to carry out this type of activity with the ability to avoid all hazards.

## 2. Special safety instructions.

### Read carefully!

- The electrical equipment is designed and manufactured in such a way as to allow safe operation and use by unqualified persons. Despite all the measures taken by the manufacturer for safe use, operation and use, there are certain residual risks and the possible dangers associated with them.
- The following symbols and their meanings have been used on the device and in the accompanying documentation to warn of possible dangers:



This symbol alerts users to the fact that if the safety instructions for the use and operation of the device are not observed, there is a risk of:

Danger of serious injury or death! Danger of equipment damage or other property damage!



This symbol alerts users to the fact that if the safety instructions for the use and operation of the device are not observed, there is a risk of:

Danger of cutting or puncture of fingers!



This symbol means that the product is made with double insulation between dangerous live parts (parts with dangerous mains voltage) and parts that are accessible during normal use. Only use identical spare parts for repairs.



This symbol means that the protection is provided by a safe low voltage supply, e.g. using a safety protection transformer.

### Transport/Transfer

- When transporting and carrying, be careful when moving to avoid tipping over, falling and damaging the device.  
There is a risk of damaging the device!

### Unpacking/Packaging

- Unpack the device and accessories before putting them into operation and dispose of all parts of the packaging materials, labels and tags. Keep packaging materials in a safe place or keep them out of the reach of children and incompetent persons.  
Risk of serious injury!  
Danger of suffocation!

## **Inspection/Commissioning**

- We recommend performing initial and subsequent regular inspections of the device. Use the device only with accessories supplied and approved by the manufacturer.
- Never use the appliance if it is incomplete, damaged or its parts or accessories have been damaged during use (eg due to a fall).  
Risk of serious injury!
- Before commissioning, check and assemble the device according to the instructions in the „Before use“ section.  
Risk of serious injury!

## **Operation/Use Warning!**

- This device may only be used with original and undamaged parts and accessories.  
Suitability and proper use are specified in the „Use“ section.  
Danger of serious damage to health!

## **Warning!**

- The device must be kept dry.
- Do not use or place the device near containers containing water. If the device falls into water, turn it off and allow the device to dry completely.
- If the device subsequently shows signs of malfunction or damage, take it to a specialist garage for inspection.
- Never overload the device beyond the limits set by the technical parameters!
- Do not expose the device to:
  - direct sunlight, sources producing excessive heat,
  - vibration and mechanical stress,
  - polluting chemicals,
  - water and excess moisture,
  - insects, plants,
  - aggressive environmental influences.

Risk of serious injury!

There is a risk of damage to the device or other property damage!

- Observe the operating mode of the device (operating time and breaks) in accordance with the operating instructions. Clean the device regularly. Contamination of the equipment can result in reduced operating parameters and possible consequent irreversible damage.
- Never disassemble this safety part / component (mechanical, electrical) if it is part of the device! Do not use the device if the safety part / component is damaged or non-functional!
- Charge the device for at least 3 hours before using it for the first time.
- After charging the device, grasp the plug when disconnecting the USB plug. Do not pull on the wire.
- Do not use the appliance when the container is empty.
- Shake the device gently while mixing.
- The appliance is intended for household use. It is not intended for professional use.
- Use the device only for its intended purpose.
- Always store the device on a flat and dry surface.
- Avoid contact with moving parts.



## Built-in battery notices

- The device is powered by a rechargeable battery, charge it only with suitable chargers approved by the dealer and designed for this device.
- If you do not have a charger, the battery is charged while connected to a PC via the supplied USB cable.
- Unplug the charger from the electrical plug and the device when not in use.
- Do not leave a fully charged battery connected to a charger, since overcharging may shorten its lifetime.
- If you do not use a fully charged battery, it will discharge itself over time.
- Never use a damaged charger.
- Battery capacity and life will be reduced if you leave the device in hot or cold places.
- Always try to keep the battery between 15 °C and 25 °C (59 °F and 77 °F).
- Battery performance is particularly limited in temperatures well below freezing.
- The rechargeable battery is located inside the device and is not accessible to the customer. It is strictly forbidden to disassemble, compress or puncture the device.
- Do not dispose of unnecessary batteries in a fire as they may explode.
- The battery may explode even if damaged.

## Cleaning, maintenance of equipment and its accessories

### Follow these procedures and instructions when using and cleaning the device:

- Zariadenie neumývajte drôtenkou alebo abrazívnymi či korozívnymi čistiacimi prostriedkami.
- Zariadenie nenechajte spadnúť, neudierajte a netraste ním. Drsným zaobchádzaním ho môžete poškodiť.
- Príslušenstvo neumývajte v umývačke riadu.
- Zariadenie sa nepokúšajte otvoriť.
- Zariadenie (telo s elektrickými časťami) nikdy nečistite spôsobom, pri ktorom by mohlo dôjsť k ponoreniu do kvapaliny a k natečeniu kvapaliny do zariadenia. Elektrické časti očistite len navlhčenou tkaninou a utrite do sucha alebo nechajte uschnúť. Zariadenie udržiajte v čistom a suchom stave.
- Nádobu zariadenia nedezinfikujte v mikrovlnnej rúre.

## Storage

- Store the device in an upright position. Place it in a ventilated and dry place to prevent direct sunlight.
- Place the appliance in a place out of the reach of children.
- Do not place or use the device near containers containing water. Do not remove the device if it falls into the water!

**Never underestimate the possible dangers and take extra care !!!**

## Description of parts

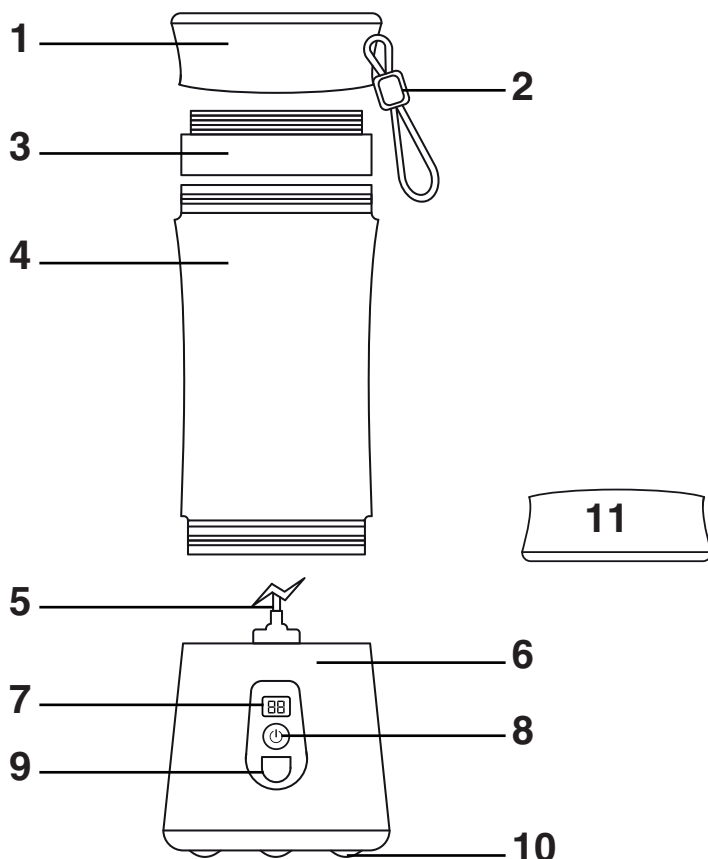

- 1. container cover - top
- 2. silicone strap for carrying
- 3. threaded strainer
- 4. the blender jar 400 ml
- 5. blender knives
- 6. the base with engine
- 7. LED display
- 8. the button  (on/off)
- 9. charging USB-C connector
- 10. rubber feet
- 11. container cover - bottom

## Power supply

The device is powered by a built-in 4 000 mAh, 7.4 V Li-ion battery. The battery is charged from a suitable AC adapter with a 5 V, 1 000 mA DC output voltage using the supplied charging cable with a USB connector and a USB-C connector.

Connect the AC adapter to an electrical outlet, connect the USB connector of the cable to the AC adapter, and connect the micro-connector to the micro-connector on the device.

You can also power the device from a PC by connecting the PC and this device with the supplied cable.

## Operation

1. **Charge the device before using it for the first time.** Connect the USB-C connector of the supplied cable to the power connector (9) on this unit and the other USB connector to the USB connector on the optional AC adapter (DC output voltage 5 V, 1,000 mA) or to the USB connector on a turned on PC. Plug the AC adapter into an electrical outlet.
2. During charging, **Ch** will light up on the charging LED display (7) and when **Fu** lights up on the display, the battery is fully charged. Disconnect the device from the charging source and you can use it.
3. If the LED on the **Lo** display lights up, the battery must be charged.
4. If the LED on the **Er** display flashes quickly, the mixer bowl (4) is not inserted correctly. Replace the blender jar.
5. If the **Er** flashes slowly on the LED display, the device motor is blocked. Remove the hard food from the blender jar and start mixing again.

## Assembly of accessories and mounting on the motor unit

Follow the steps below to assemble the appliance for food processing.

1. Always start by adding a liquid (such as water, milk or juice). This will make mixing easier.
2. Cut the ingredients into small pieces (approx. 1.5 cm pieces) to achieve a perfect result.
3. After pouring the liquid, add the ingredients to the rest of the drink to 60% of the bottle volume and mix!
4. Close the blender jar clockwise. Press the on/off button (8). The device works for about 20 seconds per switch-on.
5. For maximum performance, you can run the device upside down and allow the blades to reach their full speed before mixing.
6. To end mixing after less than 20 seconds, press button (8) switches off the device prematurely.

## IMPORTANT WARNINGS!

- Do not fill containers with hot liquids or carbonated beverages. Releasing the pressurized container can cause it to rupture and injure.
- Do not process hot food or boiling liquids. Allow to cool to at least 60 ° C before mixing.
- Do not operate the appliance if its container is empty.
- Do not use the device continuously for more than 1 minute. The recommended use time is 1 minute. This must be followed by a break of about 3 minutes.
- Add a little water to the mixed food if necessary.
- Peel the fruit / vegetables, remove the stones and kernels and cut them into smaller pieces before placing them in the container.  
Before placing in the container, you must pre-cut the hard fruits and vegetables into pieces measuring about 1 cm. Even softer types of food should be pre-cut into smaller pieces before mixing. This will increase the mixing efficiency. If you are preparing a multi-ingredient dish that requires mixing the individual ingredients at different performances, mix the individual ingredients separately.
- Do not overfill containers to avoid damaging them.
- For optimal results, it is recommended not to fill more than half the capacity of the container and pieces of solid food should not exceed about 15 mm.
- To slice the fruit/vegetables, place the fruit/vegetables in a container in the amount of half a cup. Mix continuously until you reach the desired consistency.
- To mix fruit/vegetables, add half a cup of water to half a cup of fruit/vegetables in the container to the hard fruit / vegetables. For soft fruits/vegetables, add about 1/4 cup of water to 1/2 cup of fruit/vegetables to the container.
- Avoid premixing. Premixing produces a slurry consistency.
- Do not overfill the mixing bowl.
- Fill the container with liquids first, then the solids (unless prescribed otherwise).
- When mixing drinks, you can put all the ingredients in the container at the same time.
- Only mix ice when there is an adequate amount of liquid in the container.
- If mixing stops during operation and **Er** flashes slowly on the display, select a portion of the food and start mixing again.
- Wipe off food residue from the container and knives with a rubber spatula or water jet.

## Preparation times and speed settings

Ingredient	Mixing time
fruits, vegetables cut into smaller pieces	30 s
smoothies and cocktails	40 s
soups	30 s
baby food, sauces	40 s

The processing time of the ingredients depends on how thoroughly you want to mix the food.

## Cleaning and maintenance

When mixing is complete, unplug the appliance.

Wash the container in warm water with detergent, wipe it off and dry it carefully. Do not leave parts wet.

Clean the lockable cover with knives with the supplied brush.

Do not use solvents or harsh cleaners to clean any elements.

Wash the parts immediately after use to prevent food residues from drying out. Wash the knives with a dish brush. Do not immerse them with your hands under water, as they are very sharp.

Do not wash the knives with the cover in the dishwasher. There is a seal on the knife assembly. Do not attempt to disassemble it. This seal can be damaged by heat in the dishwasher.

Never immerse the cover in water or any other liquid!

Wipe the base with the motor and the power cord with a dry cloth. The engine is lubricated with durable Vaseline. Does not require lubrication.

Never store containers with caps on. The cover prevents the ventilation of odors from the containers and thorough drying.

### Warning!

The knives are very sharp. Handle them carefully. Keep them out of the reach of children.

## Technical specifications

<b>Power supply:</b>	optional AC adapter with 5 V DC output, 1,000 mA (not supplied) built-in Li-ion battery, 4 000 mAh, 7.4 V
<b>Power consumption:</b>	130 W
<b>Container capacity:</b>	400 ml
<b>Dimensions (W x H x D):</b>	8,4 x 25,5 x 8 cm (with container)
<b>Weight:</b>	0.5 kg (motor base with container)
<b>Speed:</b>	20 000 rpm $\pm$ 10%
<b>Continuous operation time (KB):</b>	max. 20 sec.
<b>Noise:</b>	78 dB (A)

The declared noise emission value of this appliance is 78 dB (A), which represents the sound power level A with respect to the reference sound power of 1 pW.

We reserve the right to make changes!

**Producer:**

ORAVA retail 1, a.s.  
Seberíniho 2  
821 03 Bratislava  
Slovenská republika

**Importer:**

ORAVA retail 1, a.s.	ORAVA distribution CZ, s.r.o.
Seberíniho 2	Ostravská 494
821 03 Bratislava	739 25 Sviadnov
Slovenská republika	Česká republika

**INSTRUCTIONS AND INFORMATION REGARDING THE DISPOSAL OF USED PACKAGING**

Dispose of used packaging material at a municipal waste disposal site.

**DISPOSAL OF USED ELECTRICAL AND ELECTRONIC EQUIPMENT**

This symbol on the products or in the accompanying documents means that used electrical and electronic products should not be mixed with general household waste. For proper disposal, recovery and recycling, please return these products to designated collection points. Alternatively, in some countries of the European Union or other European countries, you may return your products to your local retailer when purchasing an equivalent new product. By ensuring this product is disposed of correctly, you will help prevent potential negative consequences for the environment natural resources and help prevent potential negative effects on environment and human health, which could be the consequences of improper disposal waste. Contact your local authority or nearest office for more details collection point. Improper disposal of this type of waste may result in penalties in accordance with national regulations.

**For business entities in the countries of the European Union**

If you wish to discard electrical and electronic equipment, please request the necessary information from your seller or supplier.

**Disposal in other countries outside the European Union**

This symbol is valid in the European Union. If you wish to discard this product, please request obtain the necessary information on the correct method of disposal from the local authorities or from the your supplier.



This product complies with all the essential requirements of the EU directives that apply to it.