



Acuvac

Instruction manual

EN



Battery vacuum cleaner

Intended use of the device

The household vacuum cleaner is intended exclusively for dry vacuuming of dust particles and common household dirt (e.g. fibers, hair, etc.) on dry surfaces, to the extent determined by technical and operational parameters and functions, safety and user instructions and external influences of the operating environment.

ORAVA electrical devices are manufactured according to state-of-the-art knowledge and recognized safety rules. Nevertheless, improper or improper use or improper use may result in injury or endangerment to the life of the user or a third party or to a third party. damage to equipment and other property.

1. GENERAL SAFETY INSTRUCTIONS AND WARNINGS

- This document contains important safety instructions and warnings for safe, correct and economical operation of the electrical equipment. Its compliance helps the user avoid risks, increase reliability and product life.
- In this document, the general term product is used in text parts such as:
electrical equipment - any device used for the production, conversion, transmission, distribution or use of electricity.
- From the point of view of the purpose of using electricity, the concept of electrical equipment in the strict sense of the word will include the following categories:
 - household electric devices,
 - information and communication equipment,
 - consumer electronics,
 - lighting equipment,
 - electrical and electronic tools,
 - toys and equipment for sporting and recreational purposes,
 - medical devices (aids),
 - monitoring and control devices,
 - vending machines.

1.1 General safety instructions

- Before operating the unit, we recommend that you carefully read the instruction manual and operate the equipment in accordance with the instructions!
- The safety instructions and warnings in this manual do not cover all the possible conditions and situations that may arise when using the device. The user must understand that a factor that cannot be incorporated into any of the products is personal responsibility and caution. These factors must therefore be ensured by users serving this device.

- Failure to follow the safety instructions and warnings is forbidden by the manufacturer for any damage to health or property!
- Keep the instruction manual as close to the device as possible throughout its service life. Always keep the instruction manual together with the device for future use and use by new users.
- Use the device only for the intended purpose and in the manner specified by the manufacturer.
- The device is intended for home and similar indoor use without special focus.
- This device is intended, in addition to domestic use, for the following uses:
 - in shops, offices and other similar work environments;
 - in economic buildings;
 - in hotels, motels and other residential environments;
 - in bed and breakfast establishments.
- It is not a professional device for commercial use.
- Do not change the technical parameters and features of the device by unauthorized modification or modification of any part of the device.
- The manufacturer is not responsible for damages caused during transportation, misuse, damage or destruction of the equipment due to adverse weather conditions.

1.2 Safety of the operating environment

- Do not use the device in an industrial environment or outside environment!
- Do not expose the device to:
 - sources of excessive heat or open flame,
 - dripping or splashing water,
 - vibration and excessive mechanical stress,
 - insects, animals and plants,
 - aggressive and chemical substances.
- The operating environment of the device must always be in accordance with the basic characteristics set out.
- Features of the operating environment:
 1. Ambient temperature: $+5 \div +40^{\circ}\text{C}$
 2. Humidity: $5 \div 85\%$
 3. Altitude: $\leq 2\,000\text{ m}$
 4. Occurrence of water: intermittent condensation of water or occurrence of water vapor
 5. Occurrence of foreign bodies: quantity and type of dust are insignificant
 6. Protection degree: min. IP20 (device protected from touching dangerous parts by hand and non-waterproof)

- This degree of protection is not indicated on the product and on the technical parameters in the operating instructions.
- If the protection class of the product is different from IPX0, this information is then displayed on the label of the device or in the technical data of the operating instructions.
- Other characteristics of the domestic operating environment (mechanical stress - vibrations and vibrations, occurrence of plant, animals, weather effects ...) are negligible in terms of effect on the correct and safe use of electrical equipment.

1.3 Electrical safety

- Before connecting the device to the power supply for the first time, make sure that the voltage on the device label corresponds to that of the household electrical outlet.
- The electric device is designed to power from 1/N/PE ~ 230 V 50 Hz.
- The electrical safety of the device is guaranteed only if it is properly connected to the mains.
- Electrical protection class I equipment is equipped with a protection against electric shock by means of protective earthing of inanimate parts, which can become dangerous when the device is malfunctioning. Always connect such devices to properly installed mains sockets that are equipped with earthing conductors and have a properly grounded earthing conductor.

All electrical equipment is equipped with a three-wire power supply.

- Class II electrical equipment is protected against electric shock by double insulation or by enhanced insulation of hazardous live electrical parts. Device of protection class II it must not be equipped with means to connect protective earthing.

All electrical equipment is equipped with two-wire power supply.

- Class III electrical equipment is a device that is powered by a small safe voltage source (battery or accumulator) and does not present any danger to the user from electrical shock.
- In order to provide increased safety against the risk of electric shock due to the use of electrical devices by laypersons, it is recommended to install the power supply circuit for sockets with a rated current not exceeding 20 A RCD with a rated operating current not exceeding 30 mA.

To ensure the safety and correctness of the electrical installation, consult a qualified electrician.

- Only use a power cord with a plug (mains lead) supplied with the device and compatible with a wall socket. Using another cable may result in fire or electric shock.
- Always connect an electrical device to an easily accessible mains

socket. In the event of an operating fault, the device must be switched off as soon as possible and disconnected from mains supply.

- The power cord and mains plug must always be easily accessible for safe disconnection of the electrical device from the power supply.
- Do not pull off the power cord by pulling the cable. Disconnect the power cord by pulling the plug behind the power cord plug.
- If you use an extension cord, make sure that the total rated power of all devices connected to the extension cord does not exceed the max. current load on the extension cable.
- If you need to use an extension cord or power supply block, make sure that the extension cord or power pack is plugged into a power socket, and not to another extension cord or power supply. The extension power cord or power supply block must be designed for grounded electrical plugs and connected to a properly grounded electrical socket.
- The power plug of the device must be compatible with the mains socket. Never use any adapters or modify the socket in any other way. Do not use inappropriate or damaged drawers!
- To avoid electrical shock, plug the power cables into properly grounded electrical sockets. If the device is equipped with a 3-pole plug, do not use adapters that do not have a grounding element or remove the grounding element from the plug or adapter.
- Do not bend, crush or otherwise expose the power cord of the device to mechanical stress or external heat sources. Damage to the power cord may result in electric shock.
- When the power cord is damaged, disconnect the device from the mains and do not use it again.
- If the power cord is damaged, it must be replaced by the manufacturer, its service department or a similarly qualified person to avoid the risk of electric shock.
- Regularly check and maintain the electrical device as well as the power cord and power socket. Disconnect the power plug regularly and clean it if necessary. Pollution by dust or other substances may cause disruption of the insulating state and consequently fire.
- Do not expose the device to water or moisture. The ingress of water into the device increases the risk of electric shock.
If the power cord is wet or the water has penetrated the water, disconnect it immediately from the mains. If the device is plugged into a mains socket and if possible, turn off the power circuit before attempting
unplug the power. If you are pulling wet wires from a live power source, be very careful.
- If the electrical equipment is installed (connecting) the protective covers are dismantled, the electrical parts must not be accessible to the user when the installation is finished.

1.4 Safety of persons

- This device is intended for use and operation by persons without electrotechnical qualification - lay people, according to the instructions specified by the manufacturer.
- Device operation includes activities such as switching on and off, user manipulation and setting of operating parameters, visual or auditory inspection of the equipment, and user cleaning and maintenance.
- This device can be used by children under the age of 8 and persons with reduced physical, sensory or mental capabilities or lack of experience or knowledge when supervised or instructed to use the device safely and understand the dangers involved.
- Children may not play with the device.
- Cleaning and maintenance for users may not be performed by children unattended.
- Always keep the device out of reach of children during use and operation. Be sure to unplug the device even for a freely accessible power cord.
- Always be careful when operating the electric device! Do not use an electric device if you are overly tired, under the influence of medication or narcotic drugs that reduce attention and focus.
- Inattention during operation may result in serious injury.

1.5 Cleaning, maintenance and repairs

- Observe the normal user cleaning and maintenance of the device in the recommended way. Do not use solvents or harsh cleaners for cleaning. Pollution and visible stains from finger contact, respectively. The hands can be cleaned using detergent detergents specially designed to clean household devices.
- If you do not use the device, clean it or disconnect the device from the power supply when the device is faulty.
- Electrical devices that are cleaned after use and are not intended to be completely or partly immersed in water or other liquid, protect against the effects of dripping and / or splashing water and before immersion.
- Electric household devices, like all other technical devices, are subject to the surrounding environment and natural wear. Since the legal framework of regular maintenance is not laid down for lay-in electrical household devices, the manufacturer recommends that the user have the device checked and cleaned at least once a year by a specialist workshop.
- By doing so, it is possible to achieve safety, operational reliability and increased service life.
- Do not disassemble the electric device! The device works with a dangerous voltage. For this reason, always switch off the device and disconnect it from the mains supply during user maintenance. In the event of a fault, please have the repair serviced by an authorized service center.
- Before calling a service:
 1. Verify that you are unable to remedy the malfunction yourself according to the procedure described in the chapter „Remedy of operating faults“.
 2. Turn the device off and on to make sure the fault reappears.
 3. If the malfunction of the device still persists after these operations, call the nearest specialist service center.
- Never repair the electric device yourself!
- Unauthorized, unqualified and improper use of an electric device may result in electric shock or other serious injury.
- Only carry out the warranty or post-warranty repair of an electrical device to an authorized qualified person (*).

(*) Competent qualified expert: the sales department of the manufacturer or importer or the person qualified and authorized to carry out this type of activity with the ability to avoid all risks.

2. Special safety instructions.

Read carefully!

- The electrical device is designed and manufactured in such a way as to allow safe operation and use by unauthorized personnel. Despite all precautions taken by the manufacturer for safe use, operation and use, there are certain residual risks and potential hazards associated with them.
- The following symbols and their meanings have been used on the device and in the accompanying documentation to indicate potential hazards:



This symbol alerts users that the device is operating with hazardous electrical voltages. Do not remove the protective covers on the device.

Failure to follow the safety instructions while using and operating the device may result in:

Risk of electric shock! Risk of serious injury or death!



This symbol alerts users that if the safety instructions for using and operating the device are not followed, there is a risk of:

Risk of serious injury or death! Risk of device damage or other property damage!



This symbol indicates that the product is made with double insulation between hazardous live parts (parts with dangerous voltage from the power supply) and parts that are accessible in normal use.



This symbol indicates that protection against electric shock is ensured by a safe low voltage (SELV), so that the device is operated only by batteries or a rechargeable battery. The battery is not

repeatedly charged outside the device.

The main part of the device is designed as a protection class III construction.

Transportation/Transfer

- During transport and use e.g. Take care when moving the truck to prevent the device from toppling over.
- Do not carry the device until the mains is disconnected.
- The device is intended for manual operation/moving and carrying when in use.
- Carry the device by its grip when carrying it. Do not move or carry the device by the power cord. Risk of serious injury or death! Risk of equipment damage!

Unpacking/Packaging

- Unpack the device and accessories before use and dispose of all parts of the packaging materials, etiquettes and labels. Store the packaging materials in a safe place or keep them away from children and incapacitated persons.
Risk of serious injury!
Risk of suffocation!

Inspection/Commissioning

- We recommend performing initial and subsequent regular inspections of the device.
- Do not use the device without the required filters and accessories.
- Never use the device if it is incomplete, damaged or parts or accessories have been damaged during use (e.g. due to a fall).
- Pay special attention to the regular status and operation of the AC adapter.
- Clean the device before commissioning according to the instructions in the „Commissioning“ section. „Cleaning“.
- Never clean the device (body with electrical parts) and the AC adapter in a way that could cause liquid to flow into the device.
- Clean these parts only with a damp cloth and wipe them dry or allow them to dry.
- Clean the unit only when it is turned off and unplugged.
Risk of electric shock!
Risk of serious injury!

Operation/Location/Supervision

Warning!

- The device is equipped with an AC adapter for recharging the built-in battery. The mains adapter operates with a dangerous mains voltage, therefore strictly observe the following safety instructions and warnings:
 - To charge the built-in battery, use only the supplied accessories and the AC adapter supplied by the manufacturer or a type that is specified and approved by the manufacturer.
 - Only charge the battery indoors.
Select the location and installation of the battery charging holder to prevent the occurrence of potentially dangerous situations as much as possible.
 - Do not expose the power adapter and the cord to sources of excessive heat, mechanical influences, water or other liquids and excessive moisture.
 - Make sure that the device is turned off before connecting the AC adapter to the mains.
 - Check the mains lead or cord for damage before each use. Do not use the power supply if you find any damage.
 - Do not unplug the AC adapter from the wall socket by pulling on the cord.

- Do not leave the AC adapter plugged into an electrical socket when the device is not placed in the charging cradle and the battery is not charging.
- Do not use the AC adapter if it has been dropped, if it shows signs of malfunction or damage, if it heats up excessively or makes abnormal noises.
- If the AC adapter is connected to the mains, the surface of the UPS may become slightly warm when the battery is being charged. This is a normal operating condition and is not a malfunction.
- If the AC adapter or power cord is damaged, it must be replaced with a new type. Replacing the UPS the manufacturer, its specialist service or an authorized qualified person will provide for your device.
- Only use the AC adapter indoors. Take care to observe the environmental characteristics and properties to avoid a hazardous situation.
- Never connect the AC power adapter to an AC socket while your hands are wet or the power cord or device is wet. Always wipe the hands, power cord, and device thoroughly with a dry cloth.
- Do not allow the power cord to hang over the sharp edges of the furniture, as this may damage its protective insulation and create a hazard.
- Only perform cleaning and user maintenance when the device is turned off and unplugged. Never immerse the mains adapter in water or other liquids.

Warning!

- The device and the AC adapter can be equipped with unattended power supplies available on the network.
- The device is never accessible unattended and accessible and essential with access to the network. Children, incapacitated persons or animals should be able to pull the device off the cord and potential injury.
Risk of electric shock!
Risk of serious injury!

Warning!

- Hoovering of dry dirt does not require special precaution while in use. Use correct accessories for hoovering.

Warning!

- Do not use the device for vacuuming grease, lubricants and substances such as:
 - fats, oils and the like.
- Do not use the device for vacuuming technical materials such as:
 - sharp glass and metal particles, remnants of building material pieces, etc.

- Do not use the device for vacuuming chemical and toxic materials and particles such as:
 - chlorine and ammonia cleaners, bleaches, etc.
- Do not use the device to vacuum easily flammable and flammable materials and their particles such as:
 - solid and / or liquid lighters, petrol, thinners and the like.
- Do not use the device for picking up hot objects, materials or particles such as:
 - cigarette butts and cigarette ash, carbons and coal ash, matches and the like.
- Vacuuming very fine particles can block the dust filter pores and reduce the suction power of the device. In this case, the filter must be cleaned / replaced even if the dirt tank is not filled.
- If a larger object is sucked in and the suction line becomes blocked, switch off the device immediately. Do not continue to use the device until the object has been removed and the suction line has been released and cleared.
- Only place the device on a flat and stable surface.
- Do not place the device:
 - uneven and dirty surfaces,
 - on the edges of tables or furniture parts,
 - near sources of excessive heat and open fire,
 - in the vicinity of containers containing water or other liquids. Risk of serious injury!

There is a risk of damage to the equipment or other property damage!

Warning!

- Do not use the device to vacuum textiles and clothing directly on persons!
- Do not use the device to vacuum animal hair and hair directly on pets!
- Do not expose yourself (body parts, cheeks, hair, loose clothing, etc.), other people or animals to the suction line (suction line) or accessory attachments when using the device (while the device is in operation). Risk of serious injury!
- Only assemble and disassemble parts and accessories, and clean and carry the unit when the unit is turned off and unplugged.
- Always turn on the device with the main switch during normal use. After use, turn off the device with the power switch. Do not use the device if the power switch does not work.
- Do not use or place the device in a place where children can reach freely.
- Do not allow children to play with the device. The device may topple over and cause injury to children.

- Mechanical damage (rupture or breakage of parts and covers, damage to insulation, etc.) can cause serious injury. Do not use a damaged device.

Risk of serious injury!

There is a risk of damage to the equipment or other property damage!

- Do not use or place the device near containers containing water. Should the device fall into the water, allow it to dry thoroughly. In such cases, take the device to a professional service center to check that it is safe and working properly.
- Do not partially cover the device. Do not insert or allow foreign bodies to enter the openings of the device's covers.
- Do not block the air vents of the covers. Air ventilation ensures correct operation, reliable and safe operation of the device.
- Always keep the device under supervision during use and operation!
- This device is not intended to be operated by a programmer, external timer or remote control, as there is a risk of fire if it is covered or incorrectly positioned.
- Never overload the device beyond the limits set by the technical parameters!
- Observe the operating mode of the device (operation/operation time and pause) according to the operating and use instructions. Clean the device regularly and empty it from dirt. Overfilling and excessive contamination can result in a reduction operating parameters, possible overheating and subsequent damage.
- If you notice any abnormal effects (sounds, odors, smoke, etc.) while using the device, turn off the device immediately and unplug it from the wall socket. Have the device checked by a specialist garage.
- If any safety part / component (mechanical, electrical) is part of the device, never put this part/component out of operation! Do not use the device if the safety part/component is damaged or malfunctioning!
- Never underestimate possible dangers and be careful!!!

Power supply

Power from built-in rechargeable battery (2 x Li-ion batteries, 7.2V)

The device is powered by a built-in rechargeable battery.

Charge the battery before using it for the first time or whenever the battery is low (the device turns off arbitrarily or cannot be turned on).

- Plug the appropriate AC adapter (5V, 2A) into the power socket and connect the USB connector of the supplied USB cable to the AC adapter and connect the USB-C connector of the cable to the USB-C connector of the vacuum cleaner.

The charge indicator starts flashing green slowly.

- The first full charge requires about 2.5 hours and the next full charge requires about 2 hours (+/- 0.5 hours).

One charge allows about 10 - 15 minutes of operation.

The charging indicator flashes red during operation when the battery is low. While charging, it will blink slowly in green and the indicator will glow solid green when fully charged.

- After charging, unplug the AC adapter from the wall socket to save power and disconnect the USB cable from the device.
- If you do not use the device for an extended period of time and then start charging, the charging indicator may not flash immediately. This is normal and does not indicate a malfunction. After charging for a while, the indicator starts to slowly turn green.
- The vacuum cleaner can also be charged from a switched-on PC with the possibility of charging via a USB connector or from a power bank. Connect the USB connector of the supplied cable to the USB connector on a powered-on PC or a charged power bank, and connect the USB-C connector to the USB-C connector on this device.

- Keep the AC adapter in use while warming up while using the device.
It is normal. When the charging process is complete, they will cool down.
- If the motor rotates slower (weaker) or slower. During operation, the LED will flash red, which means that the batteries can be fully charged.
- From time to time (about a month), the batteries can be fully discharged and then fully charged to maintain optimum performance and condition.
- Charging devices after use and charging within an ambient temperature range of 0 - 40 ° C.

HOW TO ACHIEVE THE LONGEST BATTERY LIFE

To ensure the longest battery life, we recommend:

- Store, use and charge the battery at room temperature. Too high temperatures can negatively affect its service life.
- Do not leave the battery fully charged or completely discharged for a long time.
- Do not keep the battery fully charged at all times.
- Do not discharge the battery completely.

Charging

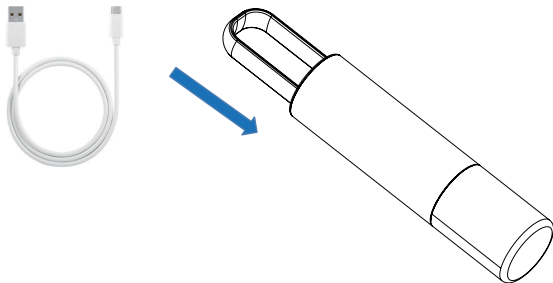

Description of parts

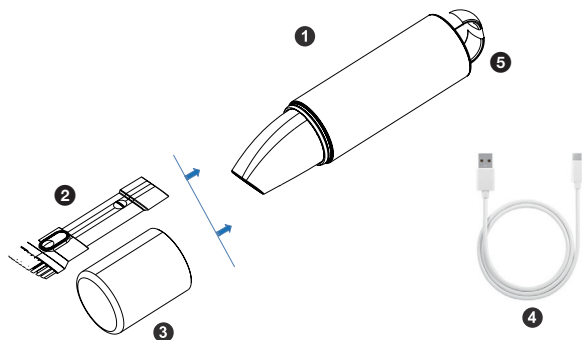

- 1 vacuum cleaner body
- 2 brush 2 in 1
- 3 suction nozzle
- 4 USB charging cable
- 5 button  (on/off)

Assembly and operation

Before first use

Unpack the device and remove all packing material. Check that the package contains all parts.

Vacuum cleaner assembly

- 1 Pull the handle and pull out the nozzle cover (3).

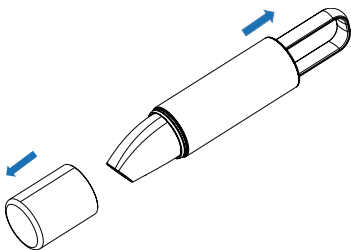

- 2 Insert the 2 in 1 brush (2) into the suction opening in the nozzle.

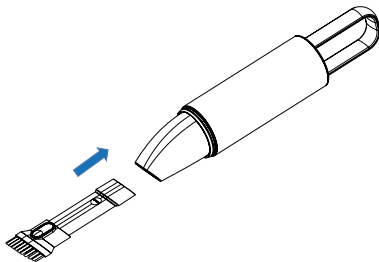

Using the vacuum cleaner

Before use, make sure that the vacuum cleaner is properly assembled and that the battery is charged.

Do not turn on the vacuum cleaner when attaching or removing accessories.

- 1 Charge the vacuum cleaner according to the charging section.
- 2 Pull out the vacuum cleaner nozzle cover.
- 3 Press button  (on/off) on the vacuum cleaner body to switch on the vacuum cleaner.
- 4 Hold the vacuum cleaner by the handle and pick up dirt.

Button  (on/off)

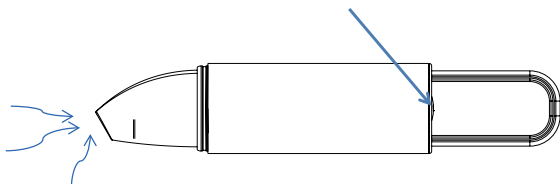

Place the 2 in 1 brush on the suction nozzle

Insert the supplied 2-in-1 brush into the suction opening in the nozzle. Nozzle will help to clean dust from PC keyboard.

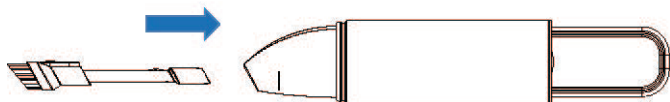

Button  (on/off)

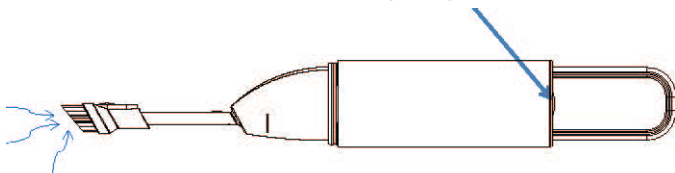

After vacuuming

- 1 Press button  (on/off) on the vacuum cleaner body to switch off the vacuum cleaner.
- 2 If you were using a brush, remove it. Put the nozzle cover on the suction nozzle and store the vacuum cleaner in a suitable dry place at room temperature.

Emptying the dirt tank and cleaning / replacing the filter

If the vacuum cleaner has poor performance, it is necessary to empty the dirt tank or clean the filter. If the suction power is greatly reduced, check that the suction nozzle or hole is not blocked.

Warning!

Switch off the vacuum cleaner before emptying the hopper.

Remark

When vacuuming new carpets or fine-fiber carpets, the tray may fill up faster, so check it more often.

Never vacuum without the dirt tank and filter in place.

Warning!

The device is only suitable for vacuuming dirt smaller than 10 mm.

- 1 With one hand, grasp the body of the vacuum cleaner and with the other hand, grasp the tray and turn the tray clockwise. The tray is released from the body and you can remove the entire tray.

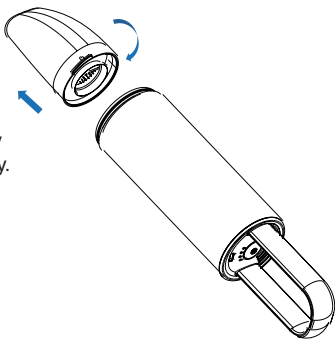

- 2** Pull out the filter assembly and empty the contents of the cartridge.

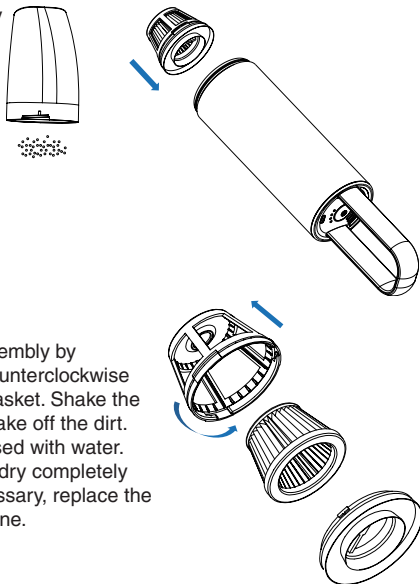

- 3** Disassemble the filter assembly by turning the filter basket counterclockwise and pulling out the filter basket. Shake the filter housing itself and shake off the dirt. Parts and filter can be rinsed with water. Both parts and filter must dry completely before reinserting. If necessary, replace the filter housing with a new one.

- 4** After cleaning and complete drying, assemble the filter assembly together in the reverse order of disassembly and place the assembled assembly in the dirt tank.
- 5** Insert the filter cartridge into the vacuum cleaner in the same way as removing it.

Warning!

Before fitting the cartridge, check that the filter is correctly inserted, protruding from the space, and does not prevent the cartridge from closing properly.

Cleaning the suction opening

If there is an object clogging the suction opening of the vacuum cleaner, proceed as follows:

- 1** Remove the attached accessories.
- 2** Remove the sucked obstruction from the suction port.
- 3** Put the accessories back into the vacuum suction opening.

Cleaning and maintenance

- Never wash the device under running water or immerse it in water.
- Clean the device surface and accessories with a soft, dry cloth or a slightly damp cloth in water.
Do not use solvents or abrasive cleaners for cleaning.
- The device must remain completely dry after cleaning.

Troubleshooting

Warning!

If you have any problems with this device, try using this report to troubleshoot. If the measures do not help, do not attempt to remove the device cover or repair it yourself. There is a risk of loss of warranty.

Operating time after full charge is too short.

- Battery life problem.
- Contact your dealer to replace the built-in batteries or dispose of the device.

The charging indicator flashes red slowly during operation.

- Batteries are low.
- Charge the device.

The charging indicator flashes red quickly during operation.

- The batteries are damaged.
- Contact your dealer to replace the built-in batteries or dispose of the device.

Technical specifications

AC adapter (not supplied):	230 VAC/50 Hz input output + 5 V (DC), 2 A
Battery operating voltage:	7.2 V (dc)
Battery:	2 x 7.2V (2x Li-ion battery, 2 Ah)
Rated power:	85 W
Charging time:	2 h \pm 0.5 h, when fully charged, the indicator glows steady green
Operating time per charge:	10 - 15 minutes
Dirt tank volume:	100 ml
Suction pressure:	5.8 kPa \pm 0.8 kPa
Dimensions (approx.):	7 x 7 x 36 cm
Weight (approx.):	0.9 kg
Noise level:	75 dB (A)

The declared noise emission value of this device is 75 dB (A), which represents the sound power level A relative to the reference sound power of 1 pW.

Special function

Microcomputer-controlled vacuum cleaner with overload protection and operating status indication

Package content:	vacuum cleaner (1) suction nozzle cover (1) brush 2 in 1 (1) USB cable (1) instructions for use (1)
-------------------------	---

Subject to change!

Producer:

ORAVA retail 1, a.s.
Seberiniho 2
821 03 Bratislava
Slovenská republika

Importer:

ORAVA retail 1, a.s.
Seberiniho 2
821 03 Bratislava
Slovenská republika

ORAVA distribution CZ, s.r.o.
Ostravská 494
739 25 Sviadnov
Česká republika

BATTERY DISPOSAL



Before disposing of the product or handing it over to a designated collection point, you will need to ensure that the built-in batteries are removed. Before removing the batteries, turn on the vacuum cleaner and wait for the batteries to discharge. Battery removal is provided by an authorized service center.

Batteries contain substances harmful to the environment and therefore do not belong in the normal household waste. Their correct disposal will be ensured by the appropriate collection point.

DISPOSAL OF USED ELECTRICAL AND ELECTRONIC EQUIPMENT



The symbol on the product or on its packaging indicates that this product does not belong to household waste. It is necessary to take it to a collection point for electrical recycling and electronic equipment.

By ensuring proper disposal of this product, you will help prevent negative consequences to the environment and human health that would otherwise be caused by inappropriate disposal of this product. For more detailed information about recycling of this product, please contact your local authority, your household waste disposal service or the shop where you purchased the product.



This product meets all the essential requirements of the EU directives that apply to it.