

Food chopper

orava

SE-303

Instruction manual

EN



Keep the Instruction for further use.



SE-303

The intended use of the device

The device is intended solely for the chopping of soft and semi-hard foods (eg nuts, spices, herbs, pulses and fruits, cheese, meat, etc.) and/or for the mixing of liquid foods and small pieces of ice, which is determined by the technical and operating parameters and functions of the equipment, the safety and user instructions and the external influences of the operating environment.

The device is not intended for grinding too hard food (eg coffee beans) or crushing ice.

ORAVA electrical appliances are manufactured according to the state of the art and recognized safety-technical rules. Nevertheless, the use or use contrary to designation may result in the risk of injury or endanger the life of the user or third person, damage to the device and other material values.

1. GENERAL SAFETY INSTRUCTIONS AND WARNINGS

- This document contains important safety instructions and warnings for safe, correct and economical operation of the electrical equipment. Its compliance helps the user avoid risks, increase reliability and product life.
- In this document, the generic term product is used in text parts such as:
electrical equipment - any device used for the production, conversion, transmission, distribution or use of electricity.
- From the point of view of the purpose of using electricity, the concept of electrical equipment in the strict sense of the word will include the following categories:
 - household electric appliances,
 - information and communication equipment,
 - consumer electronics,
 - lighting equipment,
 - electrical and electronic tools,
 - toys and equipment for sporting and recreational purposes,
 - medical devices (aids),
 - monitoring and control devices,
 - vending machines.

1.1 General safety instructions

- Before commissioning the unit, we recommend that you carefully read the operating instructions and operate the equipment in accordance with the instructions!

- The safety instructions and warnings in this manual do not cover all the possible conditions and situations that may arise when using the device. The user must understand that a factor that can not be incorporated into any of the products is personal responsibility and caution. These factors must therefore be ensured by users serving this device.
- Failure to follow the safety instructions and warnings is forbidden by the manufacturer for any damage to health or property!
- Keep the operating instructions as close to the device as possible throughout its service life. Always keep the operating instructions together with the appliance for future use and use by new users.
- Use the appliance only for the intended purpose and in the manner specified by the manufacturer.
- The appliance is intended for home and similar indoor use without special focus.
- This appliance is intended, in addition to domestic use, for the following uses:
 - in shops, offices and other similar work environments;
 - in economic buildings;
 - in hotels, motels and other residential environments;
 - in bed and breakfast establishments.
- It is not a professional device for commercial use.
- Do not change the technical parameters and features of the device by unauthorized modification or modification of any part of the device.
- The manufacturer is not responsible for damages caused during transportation, misuse, damage or destruction of the equipment due to adverse weather conditions.

1.2 Safety of the operating environment

- Do not use the device in an industrial environment or outside environment!
- Do not expose the appliance to:
 - sources of excessive heat or open flame,
 - dripping or splashing water,
 - vibration and excessive mechanical stress,
 - insects, animals and plants,
 - aggressive and chemical substances.
- The operating environment of the device must always be in accordance with the basic characteristics set out.

Operating environment characteristics:

1. Ambient temperature: $+5 \div +40$ °C
2. Humidity: $5 \div 85\%$
3. Altitude: $\leq 2\,000$ m
4. Occurrence of water: intermittent condensation of water or occurrence of water vapor
5. Occurrence of foreign bodies: quantity and type of dust are insignificant
6. Protection degree: min. IP20 (device protected from touching dangerous parts by hand and non-waterproof)
 - This degree of protection is not indicated on the product and on the technical parameters in the operating instructions.
 - If the protection class of the product is different from IPX0, this is then displayed on the device label, if applicable in the technical parameters of the operating instructions.
 - Other characteristics of the domestic operating environment (mechanical stress - vibrations, occurrence of plant, animals, weather effects ...) are negligible in terms of effect on the correct and safe use of electrical equipment.

1.3 Electrical safety

- Before connecting the appliance to the power supply for the first time, make sure that the voltage on the appliance label corresponds to that of the household electrical outlet.
- The electric appliance is designed to power from 1 / N / PE ~ 230V 50 Hz.
- The electrical safety of the appliance is guaranteed only if it is properly connected to the mains.
- Electrical protection class I is equipped with a protection against electric shock by means of protective earthing of inanimate parts, which can become dangerous when the device is malfunctioning. Always connect such devices to properly installed mains sockets that are equipped with earthing conductors and have a properly grounded earthing conductor.

All electrical equipment is equipped with a three-wire power supply.
- Class II electrical equipment is protected against electric shock by double insulation or by enhanced insulation of hazardous live electrical parts. Protection class device II must not be equipped with means for connecting a protective earthing.

All electrical equipment is equipped with two-wire power supply.
- Class III electrical equipment is a device that is powered by a low voltage (battery or accumulator) source, and does not pose any danger to the user from electrical shock.

- To ensure increased security against the risk of electrical shock when using electrical appliances by laypersons, it is recommended to install them in the electrical supply circuit for sockets with a rated current not exceeding 20 A current protector (RCD) with a rated trip current not exceeding 30 mA.
To ensure the safety and correctness of the electrical installation, consult a qualified electrician.
- Only use a power cord with a plug (mains lead) supplied with the device and compatible with a wall outlet. Using another cable may result in fire or electric shock.
- Always connect an electrical appliance to an easily accessible mains socket. In the event of an operating fault, the appliance must be switched off as soon as possible and disconnected from mains supply.
- The power cord and mains plug must always be easily accessible for safe disconnection of the electrical appliance from the power supply.
- Do not pull the power cord by pulling on the cord . Disconnect the power cord by pulling the plug behind the power cord / power cord plug.
- If you use an extension cord, make sure that the total rated power of all devices connected to the extension cord does not exceed the max. current load of the extension cable.
- If you need to use an extension cord or power supply block, make sure that the extension cord or power pack is plugged into a power outlet, and not to another extension cord or power supply. The extension power cord or power supply block must be designed for grounded electrical plugs and connected to a properly grounded electrical outlet.
- The power plug of the appliance must be compatible with the mains socket. Never use any adapters or modify the socket in any other way. Do not use inappropriate or damaged sockets!
- To avoid electrical shock, plug the power cables into properly grounded electrical outlets. If the device is equipped with a 3-pole plug, do not use adapters that do not have a grounding element or remove the grounding element from the plug or adapter.
- Do not bend, crush or otherwise expose the power cord / power cord of the appliance to mechanical stress or external heat sources. Damage to the power cord may result in electric shock.
- When the power cord is damaged, disconnect the appliance from the mains and do not use it again.
- If the power cord is damaged, it must be replaced by the manufacturer, its service department or a similarly qualified person to avoid the risk of electric shock.
- Regularly check and maintain the electrical appliance as well as the power cord and power outlet. Disconnect the power plug regularly and clean it if necessary. Pollution by dust or other substances may cause disruption of the insulating state and consequently fire.

- Do not expose the appliance to water or moisture. The ingress of water into the appliance increases the risk of electric shock. If the power cord is wet or the water has penetrated the device, disconnect it immediately from the mains. If the appliance is plugged into a mains socket and if possible, turn off the power supply before attempting to disconnect the power supply. If you are pulling wet wires from a live power source, be very careful.
- If the electrical equipment is installed (connecting) the protective covers are dismantled, the electrical parts must not be accessible to the user when the installation is finished.

1.4 Safety of persons

- This appliance is intended for use and operation by persons without electrotechnical qualification - lay people, according to the instructions specified by the manufacturer.
- Device operation includes activities such as switching on and off, user manipulation and setting of operating parameters, visual or auditory inspection of the equipment, and user cleaning and maintenance.
- This appliance can be used by children under the age of 8 and persons with reduced physical, sensory or mental capabilities or lack of experience or knowledge when supervised or instructed to use the appliance safely and understand the dangers involved.
- Children may not play with the appliance.
- Cleaning and maintenance for users may not be performed by children unattended.
- Always keep the appliance out of reach of children during use and operation. Be sure to download the appliance even for a freely accessible power cord.
- Always be careful when operating the electric appliance! Do not use an electric appliance if you are overly tired, under the influence of medication or narcotic drugs that reduce attention and focus.
- Inattention during operation may result in serious injury.

1.5 Cleaning, maintenance and repairs

- Observe the normal user cleaning and maintenance of the appliance in the recommended way. Do not use solvents or harsh cleaners for cleaning. Pollution and visible stains from fingers can be cleaned using detergent specially designed to clean household appliances.
- If you do not use the appliance, you are cleaning it, or the device is faulty disconnect the appliance from the power supply.
- Electrical appliances that are cleaned after use and are not intended to be completely or partly immersed in water or other liquid, protect against the effects of dripping and / or splashing water and before immersion.
- Electric household appliances, like all other technical devices, are subject to the surrounding environment and natural wear. Since the legal framework of regular maintenance is not laid down for lay-in electrical household appliances, the manufacturer recommends that the user have the appliance checked and cleaned at least once a year by a specialist workshop.
- By doing so, it is possible to achieve safety, operational reliability and increased service life.
- Do not disassemble the electric appliance! The appliance works with a dangerous voltage. For this reason, always switch off the appliance and disconnect it from the mains supply during user maintenance. In the event of a fault, please have the repair serviced by an authorized service center.
- Before calling a service:
 1. Turn the appliance off and on to make sure the fault reappears.
 2. If the malfunction of the appliance still persists after these operations, call the nearest specialist service center.
- Never repair the electric appliance yourself!
- Unauthorized, unqualified and improper use of an electric appliance may result in electric shock or other serious injury.
- Only carry out the warranty or post-warranty repair of an electrical appliance to an authorized qualified person^(*).

^(*)Competent qualified expert: the sales department of the manufacturer or importer or the person qualified and authorized to carry out this type of activity with the ability to avoid all risks.

2. Special Safety Instructions. Read carefully!

- Electrical equipment is designed and manufactured in such a way as to allow for safe operation and use by persons without a professional qualification. Despite all the measures taken by the manufacturer to ensure safe use and handling, it carries with it some residual risks and associated potential hazards.
- To warn of possible hazards, the following symbols and their meanings have been used on the device and in the accompanying documentation:



This symbol alerts users that the device is operating a dangerous electrical voltage. Do not remove protective covers on the device.

Failure to observe the safety instructions during use and operation of the device may result in:

Danger of electric shock! Danger of serious injury or life threatening!



This symbol alerts users to the following: • Risk of serious injury or life threatening when not following the safety instructions when using and operating the unit!

Danger of damage to equipment or other damage to property!



This symbol warns users that if you fail to follow the safety instructions when using and operating your device, you may:

Danger of cutting or pinching your fingers!



This symbol means that the product is made with a double insulation between hazardous live parts (parts with dangerous voltage from the mains) and parts that are accessible in normal use.

Transport/Carriage

- When transporting and using, for example, of the transport cart, be careful when moving, to avoid overturning the device and damaging it.
- Transport/carry the equipment only after thorough inspection of the space and the routes, which must be unobstructed.
- Never carry the machine while it is in operation. Do not carry the device while it is plugged into a wall outlet.
- Transfer the device firmly to the bottom edge of the base (container) and hold the other parts of the body.
- Make sure that your hands and equipment are not damp or slippery when carrying.

There is a risk of serious injury or life threatening!

There is a risk of damage to the device!

Unpacking/Packaging

- Unpack the equipment and accessories before putting it into service and remove all parts of packaging material and labels. Store the packaging in a safe place, especially out of the reach of children and unaccompanied persons, or dispose of them safely.
There is a risk of serious injury!
Risk of suffocation!

Check/Startup

- The appliance is designed for food preparation. Therefore, thoroughly clean all parts before commissioning, following the instructions in the „Startup“ section. „Cleaning and maintenance“.
- Never clean the appliance (its drive unit with electrical parts and controls) and the power cord with the plug in a way (under running water) that could cause the liquid to flow into the device.
- Clean these parts with a damp cloth only and wipe dry or let it dry.
- Only clean the appliance if it is switched off and disconnected from the mains.
- We recommend performing both initial and subsequent regular machine inspections.
- Never use the appliance if it is incomplete, damaged or damaged in any way during transportation or use.
- Do not use non-original and incomplete parts of the device and its accessories.
There is a risk of serious injury!
There is a risk of electric shock!

Location/Installation

- Only place the appliance on straight, strong and stable pads - kitchen work desks and furniture parts, suitable for the location of kitchen utensils.
- Always make sure that the place you want to place the device has enough space, mechanical strength, stability and appropriate lighting.

Warning!

- Do not use or dispose of the appliance:
 - to unstable tables or parts of furniture,
 - on an uneven and dirty surface,
 - on the sealing edge of tables or parts of furniture,
 - in the vicinity of containers with water or other liquids.
- Do not expose the device to:
 - direct sunlight, sources and equipment producing heat,
 - vibration and mechanical stress,
 - excessive dust,
 - water and excess moisture,
 - insect,
 - an aggressive external environment.

- Do not cover the appliance in part. Do not add anything to the device. Do not insert or allow the foreign bodies to enter the holes of the device covers.
- Do not cover the openings of the airflow covers. Air ventilation ensures reliable and safe operation of the device.
There is a risk of electric shock!
There is a danger of fire!

Warning!

- Place the device in a place where children can not reach freely.
- Prevent children from playing with the device. The device may overwhelm children and cause serious injury.
- Mechanical damage (breakage or breakage of parts and covers) of the device can cause serious injury.
There is a risk of serious injury!
There is a risk of damage to equipment or other property damage!
- Do not place or use the appliance near water-containing containers. If the appliance falls into the water, do not remove it! First, pull the power cord plug out of the mains socket and then select the appliance from the water. In such cases, take the device for inspection to a specialist service to check that it is safe and working properly.
There is a risk of electric shock!
There is a risk of electrical short circuit!

Operation/Supervision

Warning!

- This device must only be used with original parts and accessories.
- Always make sure that the device is properly assembled and that none of its parts is damaged before using the device. Do not use incorrectly assembled and damaged devices.
- Always use the appliance with a properly fitted container lid. Only the properly fitted lid (with the drive unit) will enable the safety switch to be switched on, the device switched on and its safe operation.
- Always switch off the device and unplug the power cord from the wall outlet before replacing accessories or accessible parts of the device, before installing and dismantling, or before cleaning and servicing.
There is a risk of serious injury!
- If the device has been stored at lower temperatures, first acclimate it (about ½ and 1 hour) before further use to remove any moisture inside the enclosure, solidify the moving parts and preserve the mechanical strength of the plastic parts.
- Always keep your device under control during use and operation!
- This device is not intended to be operated via a programmer, an external time switch or a remote control, as there is a risk of fire when the device is covered or incorrectly positioned.
- Always unplug it from the power supply if you leave it unattended.
- Before each connection of the appliance to the mains power supply, make sure that the controller (main switch on/ off switch) is set to „0“ (Off).

- Do not switch the device on or off by plugging in or pulling out the power cord from the AC outlet.
- Always connect the appliance to mains power supply for normal use, then turn on the main power switch.
- When you have finished using the appliance, turn off the main switch and then pull the mains cord out of the mains socket.
- Do not use the device if the main power switch does not work.
- The device is under dangerous voltage when the power supply is connected.
There is a risk of serious injury!
- The machine contains sharp-edged rotating parts - cutting blades.

Warning!

- Cutting blades are very sharp. Do not touch the blades of the cutting blades. When handling and cleaning, grasp the cutting blades behind the plastic shaft. Be very careful.

Warning!

- Do not bend your fingers and do not place other objects in the work area - inside the container and the rotating parts when it is in operation.
- If the workspace needs to be handled (cleaning the rotating parts of the trapped food) - but only when the appliance is switched off, disconnected from the power supply and the rotating parts are completely stopped, use only the specified accessories of the appliance or a suitable item, plastic knife, plastic spoon . Do not use metal objects.

Warning!

- After switching off the drive, the drive of the rotating parts will recharge for a certain amount of time. Always wait until the rotating parts stop completely before handling the equipment or the container's workspace.
There is a risk of serious injury!
There is a risk of tearing/puncture!
- Do not connect the power cord to bundles. The power cord must remain accessible for safe disconnection of the device from the power supply.
- Do not let the cord hang loose and do not allow it to be freely accessible and reachable by children.
- Never leave your device freely accessible and do not leave it with a loose cord. Children could download the device for a network cord.
- Do not store the appliance with a wrapped cord around your body. Unfold the network cord „in the way it was put in the original packaging by the manufacturer. There is a risk of serious injury!
- Never overload the equipment beyond the limits specified by the technical specifications!
- Do not switch on the appliance unless the container is filled with sufficient food / fluids. Do not switch on the appliance without the food being processed.
- Do not exceed the maximum content / volume of processed foods indicated on the container or recommended in the Food Processor Information in this manual.

- Allow the food to cool before processing the heat treated food. Do not process food with a temperature higher than 60 °C.
- Before processing deep-frozen foods, allow food to thaw first to the temperature at which food can be divided into smaller (recommended) parts. Do not process excessive pieces of deep-frozen food.
- Always divide the device into the recommended service intervals (continuous operation/break time) and follow these instructions.
- If you notice any unusual occurrences (vibrations, sounds, odors, smoke, etc.) while using the device, switch off the device immediately and disconnect it from the power supply. Have the appliance checked by a specialist workshop.

There is a risk of serious injury!

There is a risk of damage to equipment or other property damage!

- Only install and disassemble the device and its parts when the device is switched off and disconnected from mains power supply.

There is a risk of serious injury!

- Carefully clean the appliance and accessories immediately after use and dispose of all residues of processed food.
- Store the device in an upright position - especially its drive unit.
- If any safety component/component (mechanical, electrical /electronic) is part of the device, never disable this part/component! If the safety component / component is damaged or not working, do not use the appliance!
- Do not use safety parts / components to switch on / switch off the device.
- Never underestimate the potential hazards and take extreme caution !!!

Technical specifications

| | |
|------------------------------------|-----------------------|
| Power supply: | 220 - 240 V~ 50/60 Hz |
| Power consumption: | 350 W |
| Maximum container capacity: | approx. 1 200 ml |
| Usable container capacity: | approx. 750 ml |
| Weight: | 1.5 kg |
| Dimensions (WxHxD): | 19,5 x 24 x 16 cm |
| Noise level: | 80 dB (A) |

The declared value of the noise emission of this appliance is 80 dB (A), which represents level A of the acoustic power with respect to the reference acoustic power of 1 pW.

The right to make changes reserved!

Characteristic features

The device is intended for processing various foods. It enables fine chopping and mixing.
It is made of high-quality and healthy materials.

Before first use

Do not connect the device to the mains during preparations. Unpack the device and remove all packaging material from it. To remove any dirt that may have formed from the device during the packing process, clean the interior, blades and cover with a dry, lint-free cloth. Be careful not to injure yourself when cleaning sharp parts. (See the „Cleaning and Maintenance“ section of this manual). Rinse the accessories in lukewarm water. Do not submerge the motor body of the device in water! Clean the surface with a cloth moistened with water. Dry all parts thoroughly.

Never immerse the body with the motor in water or any other liquid!

For home use only!

Description of parts

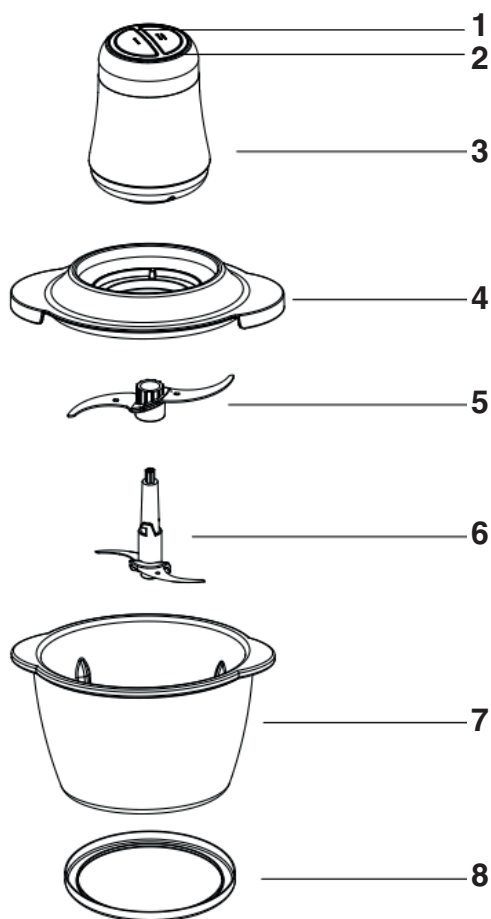

- 1** Button I (low speed)
- 2** Button II (high speed)
- 3** Motor unit
- 4** Cover (container lid)
- 5** Upper knives
- 6** Lower knives with shaft
- 7** Glass container for chopping/mixing
- 8** Rubber anti-slip mat

Assembly of accessories and use with motor unit - Fine chopping

According to the following steps, you will prepare the device for operation and chopping food finely.

1. Place the container (7) together with the non-slip mat (8) on a dry, flat and firm surface.
Do not connect the power cord to the power outlet before the device is fully assembled!
2. Fold and place the chopping knives (5, 6) in the container (7). Beware of injury, the knives are sharp!
3. If you want to chop with chopping knives, put only 1 cup (measurement) of food at a time into the container. Before processing, cut larger pieces of food into approx. 2.5 cm cubes.

Do not process more than 1 cup of food at a time!

4. Place the cover (4) with the silicone seal on top of the container (7).
5. Place the motor unit (3) on the assembled container (7) so that the protrusions on the bottom part fit into the cutouts of the container lid
6. Connect the power cord to an electrical outlet.
7. As needed, press and release the controls I/II (1,2) until you reach the desired chopping of the inserted food.
8. After finishing work, disconnect the power cord from the electrical outlet and disassemble the motor unit (3). When opening, hold the container (7) firmly with one hand and remove the cover of the container (4) with the other hand.
9. When removing food from the container (7), always remove the knives (5, 6) first. Handle knives with care. They are sharp!
Wipe food residues from the container and from the knives with a rubber spatula.

Chopping

1. Place the container (7) together with the non-slip mat (8) on a dry, flat and firm surface.
Do not connect the power cord to the power outlet before the device is fully assembled!
2. Fold and insert the chopping knives (5, 6) into the container (7). Beware of injury, the knives are sharp!
3. If you want to mix with chopping knives, put the mixed food in the container. Volume of food 0.6 l (approximately 2/3 of the volume of the container).
4. Place the cover (4) with the silicone seal on top of the container (7).
5. Place the motor unit (3) on the assembled container (7) with chopping knives (5, 6) and cover (4) so that the protrusions on the bottom of the motor unit fit into the cutouts in the container lid.
6. Connect the power cord to an electrical outlet.

7. As needed, press and release controls I/II (1,2) until you reach the desired consistency of the blended food.
8. After finishing work, disconnect the power cord from the electrical outlet and remove the motor unit (3). When opening, hold the container (7) firmly with one hand and remove the container lid with the other hand.
9. When removing food from the container (7), always remove the knives (5, 6) first. Handle the knives carefully. They are sharp!
Wipe the food from the container and from the knives with a rubber spatula.

Tips for the most efficient mixing

If you are blending solid foods, you must pre-cut hard fruits and vegetables into pieces of approx. 1 cm in size before putting them in the container. Even softer types of food should be pre-cut into smaller pieces before mixing. This will increase the mixing efficiency. If you are preparing a multi-ingredient dish that requires mixing individual ingredients at different levels, mix the individual ingredients of the dish separately.

- To cut fruits/vegetables, put the fruit/vegetables into the container in an amount of approx. 1 cup. Blend continuously until you reach the desired consistency.
- To blend fruits/vegetables, add about 1 cup of liquid to 1 cup of fruit/vegetables to the hard fruit/vegetables in the container. For soft fruit/vegetables, add about 1/2 cup of liquid per 1 cup of fruit/vegetables to the container.
- Avoid overmixing. Blend in seconds, not minutes. Premixing will create a mushy consistency.
- Do not overfill the container.
- Fill the container with liquids first, then solids (unless the recipe prescribes otherwise).
- When mixing drinks, you can put all the ingredients into the container at the same time.
- When mixing food in a solid state, cut the food into small pieces (approx. 1 cm) and add it gradually.
- Add ice one cube at a time while mixing. After mixing, you can add another cube. While mixing, gently hold the container with your hand.
- Blend ice only when there is liquid in the container. Use cups of water.
- If mixing stops during operation, turn off the device and leave it out of operation for a while.

More tips

Chopping

| Processed Food | Quantity per Dose |
|-----------------------|-------------------|
| Chocolate | Max. 100 g |
| Cheese. | Max. 200 g |
| Meat | Max. 500 g |
| Tea or spice | 50 ~ 100 g |
| Vegetables and fruits | 100 ~ 300 g |
| Onions | Max. 500 g |

Notes (Cutting):

- Do not use the appliance for a long time without breaks when cutting hard cheese or chocolate. Otherwise, the food will overheat and melt.
- Standard cutting interval: 30 - 60 seconds.

Preparation of creamy dishes

| Processed Food | Quantity per Dose |
|----------------|-----------------------------------|
| Eggs | 2 ~ 5 pcs (time: 30 ~ 70 seconds) |
| Soft cheese | 125 ~ 350 ml (time: 20 seconds) |

Notes:

- You can use the device to mix cheese and eggs and to quickly create mayonnaise or puddings.
- Do not use the device for kneading.

Overview of food processing and recommended types of food

Chopping

Fold the meat, vegetables and fruit first into smaller pieces (about 2 cm) and process them gradually.

Recommended foods: Cooked meat, poultry, apples, onions, cabbage, parsley, raw meat, tomatoes, carrot mushrooms.

Blending

Put all food together in the container and mix.

Recommended foods: Sauces, salad dressings, soups, spreads.

Complete mixing

Always feed the food first into smaller pieces (about 2 cm) and mix.

Remove the food from the container with a squeegee.

Recommended foods: cooked meat, raw and cooked fish and poultry, fruits and vegetables, buttermilk, baby food.

Cleaning and maintenance

Wash the container, cover, knives in warm water with soapy water, wipe them and dry them carefully. Do not leave parts wet.

Do not use solvents or harsh detergents to clean individual parts.

Wash the parts immediately after use to prevent food residues from drying on them. Wash the knives with a dish brush. Do not submerge them with your hands, as they are very sharp.

Parts except the motor unit can be washed in the dishwasher. Never immerse the motor unit in water or any other liquid! Wipe the motor unit and the power cord with a dry cloth. The motor is lubricated with long-lasting petroleum jelly. Does not require lubrication.

Never store attachments with covers on. The cover prevents the venting of odors from the containers and thorough drying.

Warning: The knives are very sharp. Handle them with care. Store them out of the reach of children.

ORAVA retail 1, a.s.
Seberíniho 2, 821 03 Bratislava
Slovak republic
+421 43 5306 002, office@orava.eu
www.orava.eu

INSTRUCTIONS AND INFORMATION REGARDING THE DISPOSAL OF USED PACKAGING

Dispose of used packaging material at a municipal waste disposal site.

DISPOSAL OF USED ELECTRICAL AND ELECTRONIC EQUIPMENT



This symbol on the products or in the accompanying documents means that used electrical and electronic products should not be mixed with general household waste. For proper disposal, recovery and recycling, please return these products to designated collection points. Alternatively, in some countries of the European Union or other European countries, you may return your products to your local retailer when purchasing an equivalent new product. By ensuring this product is disposed of correctly, you will help prevent potential negative consequences for the environment natural resources and help prevent potential negative effects on environment and human health, which could be the consequences of improper disposal waste. Contact your local authority or nearest office for more details collection point. Improper disposal of this type of waste may result in penalties in accordance with national regulations.

For business entities in the countries of the European Union

If you wish to discard electrical and electronic equipment, please request the necessary information from your seller or supplier.

Disposal in other countries outside the European Union

This symbol is valid in the European Union. If you wish to discard this product, please request obtain the necessary information on the correct method of disposal from the local authorities or from the your supplier.



This product complies with all the essential requirements of the EU directives that apply to it.