



PR-01

Instruction manual

EN



Please read this manual carefully before using the device and keep it for future reference.

PR-01

Designated purpose of use of the device

The device is intended exclusively for pitting cherries and similar fruits to the extent determined by technical and operational parameters and functions, safety and user instructions and external influences of the operating environment.

ORAVA products are manufactured according to current state-of-the-art knowledge and recognized safety and technical rules. Nevertheless, incorrect and unprofessional use or use contrary to the intended purpose may result in the risk of injury or endangering the life of the user or a third person, or damage to equipment and other material values.

1. General safety instructions and warnings

- The device is designed and manufactured in such a way as to enable safe operation and use by persons without professional qualifications. Despite all measures taken by the manufacturer for safe use, operation and use carry with them certain residual risks and possible dangers associated with them.
- The following symbols and their meanings have been used on the device and in the accompanying documentation to warn of possible dangers:



This symbol warns users that if the safety instructions are not followed when using and operating the device, there is a risk of: Risk of serious injury or danger to life!
Risk of equipment damage or other property damage!

Transportation/Carrying

- When transporting and carrying, be careful when moving to avoid overturning, falling and damaging the device.
There is a risk of damage to the device!

Unpacking/Packaging

- Before putting the device and accessories into operation, unpack and remove all its parts from the remains of packaging materials, labels and tags.
Put the packaging materials in a safe place or keep them especially out of the reach of children and incompetent persons.
Risk of serious injury! Danger of suffocation!

Inspection/Commissioning

- We recommend performing initial and subsequent regular inspections of the equipment. Use the device only with accessories supplied and approved by the manufacturer. Never use the device if it is incomplete, damaged or its parts or accessories have been damaged during use (e.g. as a result of a fall).
Risk of serious injury!
- Before putting the device into operation, check and assemble it according to the instructions given in the „Assembly“ section.
Risk of serious injury!

Warning!

If the silicone pad wears out due to intensive use, use the included spare pad.
Additional replacement pads are available from your dealer.

Operation/Usage

Warning!

- This device may only be used with original and undamaged parts and accessories. Suitability and proper use are determined in the „Use“ section.

Risk of injury!

- Never overload the device beyond the limits set by the technical parameters!

Do not expose the device to:

- direct sunlight, sources producing excessive heat,
- vibrations and mechanical stress,
- polluting chemical substances,
- water and excessive humidity,
- insects, plants
- aggressive environmental influences.

Risk of serious injury!

There is a risk of damage to the device or other material damage!

- Observe the operating mode of the device (time of operation/activity and breaks) according to the instructions for operation and use. Clean the device regularly. Contamination of the device may result in a decrease in operating parameters and possible subsequent irreversible damage.
- If the device includes any safety part/component (mechanical, electrical), never disable this part/component from operation! If the safety part/component is damaged or non-functional, do not use the device!
- The device is intended for home use. It is not intended for professional use.
- Use the device only for the purposes for which it is intended.
- Always store the device on a flat and dry surface.
- Avoid contact with moving parts.
- During use, use a silicone suction cup to securely attach the device to the work surface.

Warning!

- The end of the mandrel is very sharp! Take the utmost care when handling and maintaining the mandrel. Risk of injury!

Personal safety

- The device is not a toy. Place it out of the reach of children under 8 years of age and persons with reduced physical, sensory or mental capabilities.
- Children should be supervised to ensure that they do not play with the device.
- This appliance can be used by children from 8 years of age or by persons with reduced physical, sensory or mental capabilities and by persons with a lack of experience and knowledge, if they are supervised or have received instructions regarding the safe use of the appliance and understand the dangers involved.

Risk of serious injury!

There is a risk of damage to the device or other material damage!

Cleaning, maintenance of the device and its accessories

Follow the following procedure and instructions when using and cleaning the device:

- Do not wash the device with a wire brush, sand-based cleaning agents or other abrasive cleaning agents. Do not use sharp objects for cleaning.
- Do not drop, hit or shake the device. Rough handling can damage it.
- Do not wash the handle with the thorn in the dishwasher.
- Do not disinfect the container of the device in a microwave oven.

Never underestimate the possible dangers and take extra care!

Description of parts

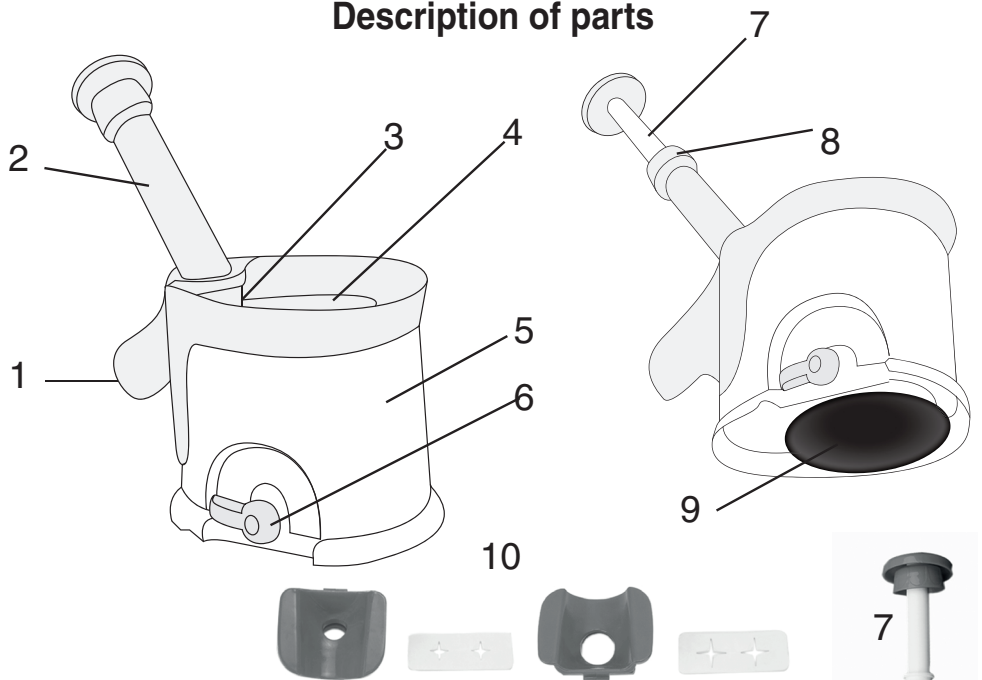

- 1 neck for pitted cherries
- 2 mandrel throat
- 3 holes for cherry pitting
- 4 tray for cherries
- 5 dice tray
- 6 suction base controller
- 7 mandrel with handle
- 8 tightening ring
- 9 suction base
- 10 cherry holders/silicone pads
- 11 spring

Assembly

Before first use, thoroughly wash and dry all parts of the product.

- 1 Place the spring (11) on the mandrel with the handle (7) and insert it into the neck of the mandrel. Then, using the tightening ring (8), tighten the mandrel to the neck of the mandrel (2). Add a suitable (depending on the size of the cherry) rubber pad to the hole at the bottom of the cherry hole (3). Place the assembled pitter on a flat, stable and smooth surface (table, kitchen work surface, etc.). Turn the suction base control (6) clockwise.

Usage

- 1 Place an appropriate amount of fresh or compote cherries without stems in the cherry container (4). Press and release the handle bar (7) to remove pits from the cherries.
- 2 The removed pits will fall into the pit tray (5) and pitted cherries will fall out through the spout (1) - place a bowl, plate, etc. under it.

Warning!

- The end of the mandrel is very sharp! Pay attention to the handling and maintenance of the mandrel maximum attention - risk of injury!

Cleaning and maintenance

Cleaning and storage

- Clean the product after each use. Do not use sharp objects or sand-based cleaning agents for cleaning. In case of heavy contamination, let the product soak.
- All parts of the pitter, except for the handle with the thorn, can be washed in a dishwasher.

Warning!

Do not wash the mandrel with the handle together with the spring in the dishwasher!

Producer:

ORAVA retail 1, a.s.
Seberíniho 2
821 03 Bratislava
Slovenská republika

Importer:

ORAVA retail 1, a.s.
Seberíniho 2
821 03 Bratislava
Slovenská republika

ORAVA distribution CZ, s.r.o.
Ostravská 494
739 25 Sviadnov
Česká republika