

Hand steamer

orava

Steameasy
Instruction manual

EN



Steameasy

Intended use of the device

The device is intended exclusively for steaming to the extent determined by the technical and operating parameters and functions, safety and user instructions, and external influences of the operating environment.

ORAVA electrical appliances are manufactured according to state-of-the-art knowledge and recognized safety regulations. Nevertheless, improper and improper use or improper use may result in injury or endangerment to the life of the user or a third party or to a third party. damage to equipment and other property.

1. GENERAL SAFETY INSTRUCTIONS AND WARNINGS

- This document contains important safety instructions and warnings for safe, correct and economical operation of the electrical equipment. Its compliance helps the user avoid risks, increase reliability and product life.
- In this document, the generic term product is used in text parts such as: electrical equipment - any device used for the production, conversion, transmission, distribution or use of electricity.
- From the point of view of the purpose of using electricity, the concept of electrical equipment in the strict sense of the word will include the following categories:
 - household electric appliances,
 - information and communication equipment,
 - consumer electronics,
 - lighting equipment,
 - electrical and electronic tools,
 - toys and equipment for sporting and recreational purposes,
 - medical devices (aids),
 - monitoring and control devices,
 - vending machines.

1.1 General safety instructions

- Before commissioning the unit, we recommend that you carefully read the operating instructions and operate the equipment in accordance with the instructions!
- The safety instructions and warnings in this manual do not cover all the possible conditions and situations that may arise when using the device. The user must understand that a factor that can not be incorporated into any of the products is personal responsibility and caution. These factors must therefore be ensured by users serving this device.
- Failure to follow the safety instructions and warnings is forbidden by the manufacturer for any damage to health or property!
- Keep the operating instructions as close to the device as possible throughout its service life. Always keep the operating instructions together with the appliance for future use and use by new users.
- Use the appliance only for the intended purpose and in the manner specified by the manufacturer.

- The appliance is intended for home and similar indoor use without special focus.
- This appliance is intended, in addition to domestic use, for the following uses:
 - in shops, offices and other similar work environments;
 - in economic buildings;
 - in hotels, motels and other residential environments;
 - in bed and breakfast establishments.
- It is not a professional device for commercial use.
- Do not change the technical parameters and features of the device by unauthorized modification or modification of any part of the device.
- The manufacturer is not responsible for damages caused during transportation, misuse, damage or destruction of the equipment due to adverse weather conditions.

1.2 Safety of the operating environment

- Do not use the device in an industrial environment or outside environment!
- Do not expose the appliance to:
 - sources of excessive heat or open flame,
 - dripping or splashing water,
 - vibration and excessive mechanical stress,
 - insects, animals and plants,
 - aggressive and chemical substances.
- The operating environment of the device must always be in accordance with the basic characteristics set out.

Operating environment characteristics:

1. Ambient temperature: $+5 \div +40$ ° C
2. Humidity: $5 \div 85\%$
3. Altitude: $\leq 2\,000$ m
4. Occurrence of water: intermittent condensation of water or occurrence of water vapor
5. Occurrence of foreign bodies: quantity and type of dust are insignificant
6. Protection degree: min. IP20 (device protected from touching dangerous parts by hand and non-waterproof)
 - This degree of protection is not indicated on the product and on the technical parameters in the operating instructions.
 - If the protection class of the product is different from IPX0, this is then displayed on the device label, if applicable in the technical parameters of the operating instructions.
 - Other characteristics of the domestic operating environment (mechanical stress - vibrations, occurrence of plant, animals, weather effects ...) are negligible in terms of effect on the correct and safe use of electrical equipment.

1.3 Electrical safety

- Before connecting the appliance to the power supply for the first time, make sure that the voltage on the appliance label corresponds to that of the household electrical outlet.
- The electric appliance is designed to power from 1 / N / PE ~ 230V 50 Hz.
- The electrical safety of the appliance is guaranteed only if it is properly connected to the mains.
- Electrical protection class I is equipped with a protection against electric shock by means of protective earthing of inanimate parts, which can become dangerous when the device is malfunctioning. Always connect such devices to properly installed mains sockets that are equipped with earthing conductors and have a properly grounded earthing conductor.

All electrical equipment is equipped with a three-wire power supply.

- Class II electrical equipment is protected against electric shock by double insulation or by enhanced insulation of hazardous live electrical parts. Protection class device II must not be equipped with means for connecting a protective earthing.

All electrical equipment is equipped with two-wire power supply.

- Class III electrical equipment is a device that is powered by a low voltage (battery or accumulator) source, and does not pose any danger to the user from electrical shock.
- To ensure increased security against the risk of electrical shock when using electrical appliances by laypersons, it is recommended to install them in the electrical supply circuit for sockets with a rated current not exceeding 20 A current protector (RCD) with a rated trip current not exceeding 30 mA.
To ensure the safety and correctness of the electrical installation, consult a qualified electrician.
- Only use a power cord with a plug (mains lead) supplied with the device and compatible with a wall outlet. Using another cable may result in fire or electric shock.
- Always connect an electrical appliance to an easily accessible mains socket. In the event of an operating fault, the appliance must be switched off as soon as possible and disconnected from mains supply.
- The power cord and mains plug must always be easily accessible for safe disconnection of the electrical appliance from the power supply.
- Do not pull the power cord by pulling on the cord . Disconnect the power cord by pulling the plug behind the power cord / power cord plug.
- If you use an extension cord, make sure that the total rated power of all devices connected to the extension cord does not exceed the max. current load of the extension cable.
- If you need to use an extension cord or power supply block, make sure that the extension cord or power pack is plugged into a power outlet, and not to another extension cord or power supply. The extension power cord or power supply block must be designed for grounded electrical plugs and connected to a properly grounded electrical outlet.
- The power plug of the appliance must be compatible with the mains socket. Never use any adapters or modify the socket in any other way. Do not use inappropriate or damaged sockets!
- To avoid electrical shock, plug the power cables into properly grounded electrical outlets. If the device is equipped with a 3-pole plug, do not use adapters that do not have a grounding element or remove the grounding element from the plug or adapter.

- Do not bend, crush or otherwise expose the power cord / power cord of the appliance to mechanical stress or external heat sources. Damage to the power cord may result in electric shock.
- When the power cord is damaged, disconnect the appliance from the mains and do not use it again.
- If the power cord is damaged, it must be replaced by the manufacturer, its service department or a similarly qualified person to avoid the risk of electric shock.
- Regularly check and maintain the electrical appliance as well as the power cord and power outlet. Disconnect the power plug regularly and clean it if necessary. Pollution by dust or other substances may cause disruption of the insulating state and consequently fire.
- Do not expose the appliance to water or moisture. The ingress of water into the appliance increases the risk of electric shock. If the power cord is wet or the water has penetrated the device, disconnect it immediately from the mains. If the appliance is plugged into a mains socket and if possible, turn off the power supply before attempting to disconnect the power supply. If you are pulling wet wires from a live power source, be very careful.
- If the electrical equipment is installed (connecting) the protective covers are dismantled, the electrical parts must not be accessible to the user when the installation is finished.

1.4 Safety of persons

- This appliance is intended for use and operation by persons without electrotechnical qualification - lay people, according to the instructions specified by the manufacturer.
- Device operation includes activities such as switching on and off, user manipulation and setting of operating parameters, visual or auditory inspection of the equipment, and user cleaning and maintenance.
- This appliance can be used by children under the age of 8 and persons with reduced physical, sensory or mental capabilities or lack of experience or knowledge when supervised or instructed to use the appliance safely and understand the dangers involved.
- Children may not play with the appliance.
- Cleaning and maintenance for users may not be performed by children unattended.
- Always keep the appliance out of reach of children during use and operation. Be sure to download the appliance even for a freely accessible power cord.
- Always be careful when operating the electric appliance! Do not use an electric appliance if you are overly tired, under the influence of medication or narcotic drugs that reduce attention and focus.
- Inattention during operation may result in serious injury.

1.5 Cleaning, maintenance and repairs

- Observe the normal user cleaning and maintenance of the appliance in the recommended way. Do not use solvents or harsh cleaners for cleaning. Pollution and visible stains from fingers can be cleaned using detergent specially designed to clean household appliances.
- If you do not use the appliance, you are cleaning it, or the device is faulty disconnect the appliance from the power supply.
- Electrical appliances that are cleaned after use and are not intended to be completely or partly immersed in water or other liquid, protect against the effects of dripping and / or splashing water and before immersion.
- Electric household appliances, like all other technical devices, are subject to the surrounding environment and natural wear. Since the legal framework of regular maintenance is not laid down for lay-in electrical household appliances, the manufacturer recommends that the user have the appliance checked and cleaned at least once a year by a specialist workshop.
- By doing so, it is possible to achieve safety, operational reliability and increased service life.
- Do not disassemble the electric appliance! The appliance works with a dangerous voltage. For this reason, always switch off the appliance and disconnect it from the mains supply during user maintenance. In the event of a fault, please have the repair serviced by an authorized service center.
- Before calling a service:
 1. Turn the appliance off and on to make sure the fault reappears.
 2. If the malfunction of the appliance still persists after these operations, call the nearest specialist service center.
- Never repair the electric appliance yourself!
- Unauthorized, unqualified and improper use of an electric appliance may result in electric shock or other serious injury.
- Only carry out the warranty or post-warranty repair of an electrical appliance to an authorized qualified person (*).

(*) Competent qualified expert: the sales department of the manufacturer or importer or the person qualified and authorized to carry out this type of activity with the ability to avoid all risks.

Characteristics

2.Special safety instructions.

Read carefully!

- The electrical equipment is designed and manufactured in such a way as to allow safe operation and use by unauthorized personnel. In spite of all precautions taken by the manufacturer for safe use, operation and use, there are certain residual risks and potential hazards associated with them.
- To alert you to potential hazards, there were and the following symbols and their meanings are used in the accompanying documentation:



This symbol alerts users that the device is working with dangerous electrical voltage. Do not remove the protective covers on the device. Failure to follow the safety instructions while using and operating the equipment may result in:
Risk of electric shock! Risk of serious injury or death!



This symbol warns the user that if the safety instructions for use and operation of the device are not followed, there is a risk of: serious injury or death!
Risk of equipment damage or other property damage!



This symbol on the product replaces the sentence: Do not immerse in water or other liquids!
Risk of fatal injury due to the device falling into water and electric shock!



This symbol warns the user that if the safety instructions for use and operation of the device are not followed, there is a risk of burning from a hot surface!



This symbol warns the user that if the safety instructions for using and operating the device are not followed, there is a danger: Fire!

Transportation/Transfer

- Only transport/carry the equipment after thoroughly inspecting the area and routes, which must be clear of obstructions.
- Never carry the machine while it is in operation. Do not carry the device while it is connected to a power outlet.
- When carrying, ensure that your hands and equipment are not damp or slippery.
Risk of serious injury or death! Risk of equipment damage!

Unpack/Packaging

- Unpack and discard all parts and accessories of packaging materials and labels before operating the machine. Keep all packaging materials in a safe place or keep them away from children and incapacitated persons.
Risk of serious injury!
There is a risk of suffocation!

Inspection/Commissioning

- Never use the appliance if it is incomplete, damaged or any part of it has been damaged during use. Have the device repaired by a specialist garage.
Risk of serious injury!
- Children under 3 years of age must be prevented from accessing the appliance unless they are constantly supervised.
- Children between 3 years and under 8 years of age must not plug the appliance into, regulate or clean the appliance, or perform maintenance by the user.

Warning!

- Some parts of this product may become very hot and cause burns. Pay special attention when vulnerable persons or children are present.
- Cleaning and maintenance that can be performed by the user must not be performed by children without supervision. Keep the device and its power cord out of reach of children under 8 years of age when connected to a power outlet or cold.
- The appliance is designed for domestic use.
- Do not use the device in an industrial environment or outdoors.
- Before connecting the machine to the wall outlet, make sure that the nominal voltage indicated on the machine's nameplate matches the voltage in your wall outlet.
- Connect the equipment only to a properly grounded outlet.
- Do not leave the appliance unattended when it is connected to a power outlet.
- Never iron clothes on the body.
- Do not touch the warm soleplate. Doing so may cause burns.
- If your hands are wet or damp, do not touch the device that is connected to a power outlet.

There is a risk of damage to the equipment or other property damage!

Risk of electric shock!

Risk of serious injury!

- Always unplug the machine from the wall outlet before storing it for a short time or after use.
- Allow the steam panel to cool before cleaning or otherwise handling the iron that has been disconnected from the power outlet.
There is a risk of damage to the equipment or other property damage! Risk of burns!
- The device must not be used if it has been dropped, showing visible signs of damage.
- Do not allow the power cord to come into contact with water or a warm surface.
- Do not unplug the machine from the wall outlet by pulling on the power cord. Doing so may damage the power cord or the power outlet. Disconnect the power cord by pulling on the power cord plug.
- If the power cord is damaged, have it replaced by an authorized service center. It is forbidden to use the device with a damaged power cord or plug.
- To avoid the risk of electric shock, do not repair or modify the device yourself. Have all repairs carried out by an authorized service center. By interfering with the product, you expose yourself to the risk of losing the statutory right from faulty performance, eventually. quality assurance.

There is a risk of damage to the equipment or other property damage!

Risk of electric shock!

Risk of electric short circuit!

Location/Installation

- The machine must be used and stored on a stable surface.
- When placing the machine on the storage stand, make sure the surface on which the storage stand is placed is stable.
- Always make sure that the area where you want to place the device has sufficient space, stability, and mechanical strength.
- Do not place the appliance on or near electric or gas cookers and other heat sources.

Warning!

- Do not place the device:
 - for unstable racks,
 - on uneven and unstable surfaces,
 - a storage rack that is on an unstable surface.
- Do not partially cover the device. Do not place any objects on the device.

Risk of fire!

Warning!

- Place the device in a place where children cannot reach freely. Do not allow children to tamper with the device (play). The device may topple over and cause serious injury. Mechanical damage (breakage or breakage of parts and covers) of the device can cause serious injury.

Risk of serious injury!

There is a risk of damage to the equipment or other property damage!

- The device must not be left unattended when it is connected to a power outlet.
- Do not place or use this product near containers containing water. Do not remove the device if it falls into water. Unplug the power cord from the wall outlet before removing the machine from the water. In such cases, take the equipment to a professional service center to check that it is safe and working properly.

Risk of electric shock! Risk of electric short circuit!

- Always keep the unit under supervision during use and operation!
- This equipment is not intended to be operated by a programmer, external timer or remote control, as there is a risk of fire if the equipment is covered or improperly positioned.
- Do not leave the device unattended during operation, especially if there are children, incapacitated persons or animals near them.
- Do not use this product near flammable materials or objects such as. curtains, drapes, decorative fabrics and the like.

Risk of fire!

- In normal use, always connect the device to the power outlet first and then turn it on with the main power switch.
- After use, turn the power switch off with the main power switch, then unplug the power cord from the wall outlet.
- The unit contains parts and surfaces that become very hot during operation
 - steam panel.

Warning!

- Warm surfaces remain hot for some time after the unit is turned off. Always wait until the hot surfaces have completely cooled down before any further handling of the appliance - cleaning, storage and storage.

Risk of burns from hot surfaces!

- The power outlet and power cord must remain easily accessible to safely unplug the equipment.
- Never leave the appliance unattended and freely accessible with an unplugged power cord. Children, incapacitated persons or animals could pull the device away from the power cord.
- Do not store the device with the power cord wrapped around its body. Fold the power cord in the same way as it was put in the original packaging from the manufacturer.
Risk of serious injury!
- Children under 3 years of age must be prevented from accessing the appliance unless they are constantly supervised.
- Children between 3 years and under 8 years of age must not plug the appliance into, regulate or clean the appliance, or perform maintenance by the user.

WARNING!

Some parts of this product can become very hot and cause burns. Pay special attention when vulnerable persons or children are present.

Cleaning/Maintenance

Cleaning the outside of the machine

- Before cleaning, make sure that the temperature controller is set to MIN and the power cord is unplugged. Allow the steam panel to cool.
- Wipe the steam panel and the cabinet of the machine with a cloth that has been slightly moistened. Then wipe everything dry.
- Do not use metal objects, petrol, thinners or abrasive cleaners, etc. to clean the surface. Do not immerse the device in water.
- To avoid possible electric shock, do not wash the device under running water, spray water, or submerge it in water or any other liquid.
Risk of electric shock!

Technical specifications

Power supply:	230 V/50 Hz
Power input:	1200 W
Operating temperature:	55 ° C
Water tank capacity:	100 ml
Dimensions (W x D x H):	11.5 x 15.5 x 30 cm
Weight:	0.76 kg

Content of package:	steam ironing and cleaning machine (1)
	brush handle (1)
i	instructions for use (1)

Subject to change!

The machine is equipped with many features that simplify ironing in household. It has an elegant shape allowing comfortable holding, high thermal efficiency, steam system and so on.

The device can be folded for easier storage and transport.

- **Precise temperature setting**

The temperature is set very precisely and corresponds to the specific ironed textiles.

- **Thermal fuse**

If the temperature is abnormally high, the integrated thermal fuse will melt to prevent fire, thus interrupting the power supply.

In this case, it will be necessary to replace it at an authorized dealer.

Preparation

Power supply

The device operates on AC 230 V, 50 Hz from the mains.

Before using the device, you must connect the device to a power outlet using a power cord to a specified electrical outlet.

Parts description



1 Stainless steel steam panel with steam

2 Short-time steam button

The button allows batch production of steam.

3 Continuous steam ironing switch

The switch allows steam to iron stubborn wrinkles and creases.

4 Handle

5 Water tank

Open the reservoir and fill with water.

6 Power/temperature indicator

It lights up when it is turned on and goes out when the machine is ready.

Then it goes out during ironing and lights up as the operating temperature is maintained.

7 Locking element for folding the handle

8 Adjustment for better fabric alignment

9 Water tank

Use for easier filling with water

Assembly and operation

Before first use

- Unpack the machine and remove all packing material and remove any protective foils and stickers from the metal steaming surface.
- Disconnect the power cord from the wall outlet before attaching or removing the brush shaft.
- Heat the machine and iron an spare piece of cloth for a few minutes to remove any dirt from the ironing surface. A non-standard odor may be felt when first used. This is a normal process of firing production layers and does not indicate equipment damage.

Adjusting the handle

The handle of the device is foldable for easy transportation on the road and storage.

- Swing the handle to the correct operating position as shown, until it clicks.
- To return the handle to its original position, press down the handle to fold it back into its transport and storage position.

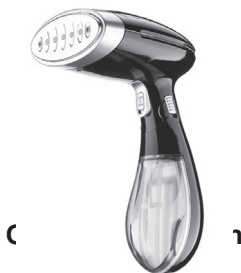

Do not put the handle in a different position as it may damage the device.

Attaching the brush shaft

The supplied brush handle can be attached to the metal steaming surface to allow steam cleaning of the garments.

- Slide the brush shaft onto the steaming surface until it clicks into place.
- To remove the brush shaft, gently pull the small protrusion on the bottom or top of the brush shaft and slide the shaft out of the steaming surface.

Filling the tank with water

- 1 Unplug the power cord before filling the tank with water. Hold the device by the hand with one hand and press the reservoir with the other hand and pull it

down.

- 2 To fill with water, open the cap and place the reservoir on the machine.



- 3 Fill the reservoir with water



- 4 Close the water filler cap until it clicks and place the reservoir back in its place on the machine.

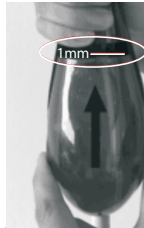

Steaming (ironing with steam)

- 1 Connect the power cord to the wall outlet. The indicator light comes on and goes out when the operating temperature is reached (after approx. 20 seconds).

All textiles marked on the ironing symbol with dots • to ••• can be ironed and brushed with the help of steam:

- : nylon, acrylic, acetate
- : silk, synthetic silk, polyester
- : wool, cotton, linen, canvas, cloth

- 2 When the operating temperature has been reached (about 20 seconds), the power/operating temperature indicator turns off and you can start working.
- 3 Steam pressure allows you to iron stubborn creases. Steam pressure can be used by pressing the button for short-term use of steam or by switching the switch for continuous ironing with steam. When ironing, either press the button or set the switch to the bottom position.
- There must be sufficient water in the reservoir.
- The indicator goes off during ironing and lights up as the operating temperature is maintained



Vertical steam ironing

Vertical steam ironing is used to iron clothes hanging on a clothes hanger. There must be sufficient water in the reservoir.

Warning!

Never do this ironing directly on the person!

- For best results, hang clothes after washing, eg. on a clothes hanger. The garment dries with fewer creases.
- While ironing, you can gently and continuously pull the garment with your other hand. However, be careful not to scald your hand.

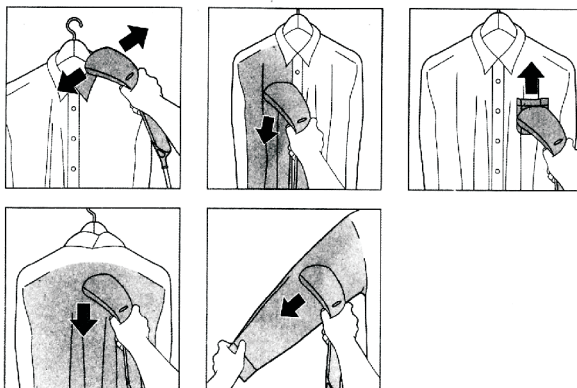

- It is not possible to produce a crisp, ironed look with this steamer. In this case, we recommend using a classic device.
- It absorbs moisture during steam ironing. Allow clothing to dry completely before storing, eg. in the closet.
- The water tank filler opening must not be opened during operation.

If the water tank is empty

Refill the tank.

- Use clean tap water without any additives (no vinegar, starch, perfumes or

plasticizers).

- If the tap water is medium or hard, mix it with distilled water.
- 1 Pull the tank straight out (as described above).
 - 2 Open the filler cap.
 - 3 Hold the water tank under the tap, fill it and close the cap.
 - 4 Put the water tank back in the machine. The water tank must audibly click into place.

Using a strong steam stream

- 1 Plug the machine into an electrical outlet. The indicator lights up.
- 2 When the machine is ready for steaming (after approx. 20 seconds), the indicator goes off.
- 3 While holding down the short-term steam button, gently move the machine along the garment. The indicator lights up and goes out during steam ironing.
- 4 If water is leaking from the steam nozzles, release the steam button to allow the unit to return to operating temperature until the indicator goes out.

Poznámky

- The steam current function can be used with or without the brush supplied.
- A smell may be felt when first used. This is a consequence of the manufacturing process and is not a malfunction. Provide adequate ventilation.

Steam cleaning

This feature provides intensive cleaning of soiled textiles by steam pressure and heat along with brushing.

The function works while brushing while holding down the short-term steam button or setting the switch to continuous steam.

- 1 Slide the brush shaft onto the metal surface until it clicks.
- 2 Connect the power cord to the wall outlet. The indicator will be lit.
- 3 When the operating temperature is reached, the indicator goes off.
- 4 Press the brief steam button, or slide the switch to the continuous steam position and perform steam cleaning by sliding the brush handle across the fabric.

Warning: Never carry out such cleaning directly on the person!

After completion

After ironing/cleaning is complete, unplug the appliance, allow it to cool in an appropriate position, and after cooling, drain any remaining water from the tank. If

you have used a brush handle, remove it.
Then store the device.

Care of clothing

- Hang the creased clothes on the clothes hanger.
- Pull one piece of laundry with one hand and steam it from top to bottom. Apply a light brush to the garment and slide the machine up and down along the laundry. The combination of steam and brush gently and thoroughly removes all creases and also has a cleaning function.

Care for curtains, drapes and upholstery

- Hang the hinges on the rail/garage.
- Proceed as described under „Care for clothing“.
- Always perform a test in a place that is not visible first.
- When using the machine horizontally, hold it vertically from time to time to achieve maximum steam output.

Ironing Tips

- Always check the label on the ironed fabric, which also contains ironing instructions. Always follow these instructions.
- The machine heats up faster than it cools down. Therefore, start ironing fabrics requiring lower ironing temperatures that contain synthetic fabrics.
- Iron and similar fabrics with fine fibers only in one direction. Apply gentle pressure and always observe the movement of the device.
- You can iron clean wool with steam. Set the steam control to the maximum position and iron with a dry cloth. After steam ironing, the fabric may begin to shine. To avoid this, iron the fabric from the opposite side.

Cleaning and maintenance

- Unplug the power cord. Never wash the appliance under running water or

immerse it in water.

- Clean the equipment and accessories with a soft cloth.
Do not use solvents, thinners, alcohol, or abrasive cleaners for cleaning.
- Dirt can be removed from the steam panel with steam nozzles using commercially available chrome, silver or stainless steel cleaners.
- The device must remain completely dry after cleaning.

Decalcification

If the steam power decreases after a certain time, descale the appliance (descaling).

Use commercially available citric acid descaling agents to remove deposits. Follow the instructions on the descaler.

- 1 Place the descaling agent in the water tank.
- 2 Plug the machine into an electrical outlet. The indicator lights up.
- 3 Allow the descaler to act for some time.
- 4 Press the short steam button and follow the brush cleaning procedure with the brush on, but use an old and unnecessary cotton fabric.
- 5 When finished, turn off the machine, remove the reservoir, empty the remaining contents of the reservoir, and rinse the reservoir well.

Warranty conditions

A warranty period of 24 months is provided for this device. When exercising the right to a warranty service, return the warranty card and the cash receipt of the equipment to the service center together with the product. The date of the warranty card and proof of purchase must be the same. If not, the warranty will not be granted.

- The right to free repair of the product during the warranty period expires if:
 - the user does not submit a valid warranty and proof of purchase of the product;
 - malfunctions due to incorrect connection, improper use and maintenance (dusty environment), mechanical damage, engine failure and residential installation;
 - do unauthorized interference or alteration in the product by an unauthorized person and/or a malfunction due to the use of non-original spare parts;
 - the appliance is not used according to the enclosed operating instructions.

Other terms and conditions related to the warranty

The shop where the device is sold to the consumer is obliged to show the device to the buyer and inform the buyer:

- the way it is used and handled;
- how warranty repairs are available;
- with the nearest warranty service as well as the way the warranty service is dispatched to the supplier's service center;
- properly fill in the warranty card. Incorrect and incomplete warranty card is void and the consumer loses the right to warranty;
- the guarantee / repair, exchange or withdrawal of the contract / are covered by the relevant provisions of the Civil Code and the Complaint Rules.

Producer:

ORAVA retail 1, a.s.
Seberíniho 2
821 03 Bratislava
Slovenská republika

Importer:

ORAVA retail 1, a.s.
Seberíniho 2
821 03 Bratislava
Slovenská republika

ORAVA distribution CZ, s.r.o.
Ostravská 494
739 25 Sviadnov
Česká republika

INSTRUCTIONS AND INFORMATION REGARDING THE DISPOSAL OF USED PACKAGING

Dispose of used packaging material at a municipal waste disposal site.

DISPOSAL OF USED ELECTRICAL AND ELECTRONIC EQUIPMENT

This symbol on the products or in the accompanying documents means that used electrical and electronic products should not be mixed with general household waste. For proper disposal, recovery and recycling, please return these products to designated collection points. Alternatively, in some countries of the European Union or other European countries, you may return your products to your local retailer when purchasing an equivalent new product. By ensuring this product is disposed of correctly, you will help prevent potential negative consequences for the environment natural resources and help prevent potential negative effects on environment and human health, which could be the consequences of improper disposal waste. Contact your local authority or nearest office for more details collection point. Improper disposal of this type of waste may result in penalties in accordance with national regulations.

For business entities in the countries of the European Union

If you wish to discard electrical and electronic equipment, please request the necessary information from your seller or supplier.

Disposal in other countries outside the European Union

This symbol is valid in the European Union. If you wish to discard this product, please request obtain the necessary information on the correct method of disposal from the local authorities or from the your supplier.



This product complies with all the essential requirements of the EU directives that apply to it.