

Steam iron

orava

Instruction manual

EN



ZE-301

The intended use of the device

The device is intended exclusively for ironing to the extent specified by the technical and operating parameters and functions, safety and user instructions and external influences of the operating environment.

ORAVA electrical appliances are manufactured according to the state of the art and recognized safety-technical rules. Nevertheless, the use or use contrary to designation may result in the risk of injury or endanger the life of the user or third person, damage to the device and other material values.

1. GENERAL SAFETY INSTRUCTIONS AND WARNINGS

- This document contains important safety instructions and warnings for safe, correct and economical operation of the electrical equipment. Its compliance helps the user avoid risks, increase reliability and product life.
- In this document, the generic term product is used in text parts such as: electrical equipment - any device used for the production, conversion, transmission, distribution or use of electricity.
- From the point of view of the purpose of using electricity, the concept of electrical equipment in the strict sense of the word will include the following categories:
 - household electric appliances,
 - information and communication equipment,
 - consumer electronics,
 - lighting equipment,
 - electrical and electronic tools,
 - toys and equipment for sporting and recreational purposes,
 - medical devices (aids),
 - monitoring and control devices,
 - vending machines.

1.1 General safety instructions

- Before commissioning the unit, we recommend that you carefully read the operating instructions and operate the equipment in accordance with the instructions!
- The safety instructions and warnings in this manual do not cover all the possible conditions and situations that may arise when using the device. The user must understand that a factor that can not be incorporated into any of the products is personal responsibility and caution. These factors must therefore be ensured by users serving this device.
- Failure to follow the safety instructions and warnings is forbidden by the manufacturer for any damage to health or property!
- Keep the operating instructions as close to the device as possible throughout its service life. Always keep the operating instructions together with the appliance for future use and use by new users.
- Use the appliance only for the intended purpose and in the manner specified by the manufacturer.
- The appliance is intended for home and similar indoor use without special focus.
- This appliance is intended, in addition to domestic use, for the following uses:
 - in shops, offices and other similar work environments;
 - in economic buildings;
 - in hotels, motels and other residential environments;
 - in bed and breakfast establishments.
- It is not a professional device for commercial use.
- Do not change the technical parameters and features of the device by unauthorized modification or modification of any part of the device.
- The manufacturer is not responsible for damages caused during transportation, misuse, damage or destruction of the equipment due to adverse weather conditions.

1.2 Safety of the operating environment

- Do not use the device in an industrial environment or outside environment!
- Do not expose the appliance to:
 - sources of excessive heat or open flame,
 - dripping or splashing water,
 - vibration and excessive mechanical stress,
 - insects, animals and plants,
 - aggressive and chemical substances.
- The operating environment of the device must always be in accordance with the basic characteristics set out.

Operating environment characteristics:

1. Ambient temperature: $+5 \div +40$ ° C
2. Humidity: $5 \div 85\%$
3. Altitude: $\leq 2\,000$ m
4. Occurrence of water: intermittent condensation of water or occurrence of water vapor
5. Occurrence of foreign bodies: quantity and type of dust are insignificant
6. Protection degree: min. IP20 (device protected from touching dangerous parts by hand and non-waterproof)
 - This degree of protection is not indicated on the product and on the technical parameters in the operating instructions.
 - If the protection class of the product is different from IPX0, this is then displayed on the device label, if applicable in the technical parameters of the operating instructions.
 - Other characteristics of the domestic operating environment (mechanical stress - vibrations, occurrence of plant, animals, weather effects ...) are negligible in terms of effect on the correct and safe use of electrical equipment.

1.3 Electrical safety

- Before connecting the appliance to the power supply for the first time, make sure that the voltage on the appliance label corresponds to that of the household electrical outlet.
- The electric appliance is designed to power from 1 / N / PE ~ 230V 50 Hz.
- The electrical safety of the appliance is guaranteed only if it is properly connected to the mains.
- Electrical protection class I is equipped with a protection against electric shock by means of protective earthing of inanimate parts, which can become dangerous when the device is malfunctioning. Always connect such devices to properly installed mains sockets that are equipped with earthing conductors and have a properly grounded earthing conductor.

All electrical equipment is equipped with a three-wire power supply.
- Class II electrical equipment is protected against electric shock by double insulation or by enhanced insulation of hazardous live electrical parts. Protection class device II must not be equipped with means for connecting a protective earthing.

All electrical equipment is equipped with two-wire power supply.
- Class III electrical equipment is a device that is powered by a low voltage (battery or accumulator) source, and does not pose any danger to the user from electrical shock.

- To ensure increased security against the risk of electrical shock when using electrical appliances by laypersons, it is recommended to install them in the electrical supply circuit for sockets with a rated current not exceeding 20 A current protector (RCD) with a rated trip current not exceeding 30 mA.

To ensure the safety and correctness of the electrical installation, consult a qualified electrician.

- Only use a power cord with a plug (mains lead) supplied with the device and compatible with a wall outlet. Using another cable may result in fire or electric shock.
- Always connect an electrical appliance to an easily accessible mains socket. In the event of an operating fault, the appliance must be switched off as soon as possible and disconnected from mains supply.
- The power cord and mains plug must always be easily accessible for safe disconnection of the electrical appliance from the power supply.
- Do not pull the power cord by pulling on the cord . Disconnect the power cord by pulling the plug behind the power cord / power cord plug.
- If you use an extension cord, make sure that the total rated power of all devices connected to the extension cord does not exceed the max. current load of the extension cable.
- If you need to use an extension cord or power supply block, make sure that the extension cord or power pack is plugged into a power outlet, and not to another extension cord or power supply. The extension power cord or power supply block must be designed for grounded electrical plugs and connected to a properly grounded electrical outlet.
- The power plug of the appliance must be compatible with the mains socket. Never use any adapters or modify the socket in any other way. Do not use inappropriate or damaged sockets!
- To avoid electrical shock, plug the power cables into properly grounded electrical outlets. If the device is equipped with a 3-pole plug, do not use adapters that do not have a grounding element or remove the grounding element from the plug or adapter.
- Do not bend, crush or otherwise expose the power cord / power cord of the appliance to mechanical stress or external heat sources. Damage to the power cord may result in electric shock.
- When the power cord is damaged, disconnect the appliance from the mains and do not use it again.
- If the power cord is damaged, it must be replaced by the manufacturer, its service department or a similarly qualified person to avoid the risk of electric shock.
- Regularly check and maintain the electrical appliance as well as the power cord and power outlet. Disconnect the power plug regularly and clean it if necessary. Pollution by dust or other substances may cause disruption of the insulating state and consequently fire.

- Do not expose the appliance to water or moisture. The ingress of water into the appliance increases the risk of electric shock. If the power cord is wet or the water has penetrated the device, disconnect it immediately from the mains. If the appliance is plugged into a mains socket and if possible, turn off the power supply before attempting to disconnect the power supply. If you are pulling wet wires from a live power source, be very careful.
- If the electrical equipment is installed (connecting) the protective covers are dismantled, the electrical parts must not be accessible to the user when the installation is finished.

1.4 Safety of persons

- This appliance is intended for use and operation by persons without electrotechnical qualification - lay people, according to the instructions specified by the manufacturer.
- Device operation includes activities such as switching on and off, user manipulation and setting of operating parameters, visual or auditory inspection of the equipment, and user cleaning and maintenance.
- This appliance can be used by children under the age of 8 and persons with reduced physical, sensory or mental capabilities or lack of experience or knowledge when supervised or instructed to use the appliance safely and understand the dangers involved.
- Children may not play with the appliance.
- Cleaning and maintenance for users may not be performed by children unattended.
- Always keep the appliance out of reach of children during use and operation. Be sure to download the appliance even for a freely accessible power cord.
- Always be careful when operating the electric appliance! Do not use an electric appliance if you are overly tired, under the influence of medication or narcotic drugs that reduce attention and focus.
- Inattention during operation may result in serious injury.

1.5 Cleaning, maintenance and repairs

- Observe the normal user cleaning and maintenance of the appliance in the recommended way. Do not use solvents or harsh cleaners for cleaning. Pollution and visible stains from fingers can be cleaned using detergent specially designed to clean household appliances.
- If you do not use the appliance, you are cleaning it, or the device is faulty disconnect the appliance from the power supply.
- Electrical appliances that are cleaned after use and are not intended to be completely or partly immersed in water or other liquid, protect against the effects of dripping and / or splashing water and before immersion.
- Electric household appliances, like all other technical devices, are subject to the surrounding environment and natural wear. Since the legal framework of regular maintenance is not laid down for lay-in electrical household appliances, the manufacturer recommends that the user have the appliance checked and cleaned at least once a year by a specialist workshop.
- By doing so, it is possible to achieve safety, operational reliability and increased service life.
- Do not disassemble the electric appliance! The appliance works with a dangerous voltage. For this reason, always switch off the appliance and disconnect it from the mains supply during user maintenance. In the event of a fault, please have the repair serviced by an authorized service center.
- Before calling a service:
 1. Turn the appliance off and on to make sure the fault reappears.
 2. If the malfunction of the appliance still persists after these operations, call the nearest specialist service center.
- Never repair the electric appliance yourself!
- Unauthorized, unqualified and improper use of an electric appliance may result in electric shock or other serious injury.
- Only carry out the warranty or post-warranty repair of an electrical appliance to an authorized qualified person^(*).

^(*)Competent qualified expert: the sales department of the manufacturer or importer or the person qualified and authorized to carry out this type of activity with the ability to avoid all risks.

Special Safety Instructions.

Read carefully!

- Electrical equipment is designed and manufactured in such a way as to allow for safe operation and use by persons without a professional qualification. Despite all measures taken by the manufacturer for safe use and handling, they carry with them some residual risks and associated potential hazards.
- To alert you to possible hazards on the device and the following symbols used in the accompanying documentation and their meanings:



This symbol alerts users that the device is operating a dangerous electrical voltage. Do not remove protective covers on the device. Failure to observe the safety instructions for use and operation of the unit may entail the following: Danger of electric shock!

Danger of serious injury or life threatening!



This symbol alerts users that the following hazards can be avoided if the following precautions are observed when operating the device:

Danger of serious injury or life threatening! Danger of damage to equipment or other damage to property!



This symbol used on the product replaces the sentence:

Do not immerse in water or other liquids!

If kettle falls in the water, there is a risk of electric shock. Its life threatening



This symbol warns users that if the safety instructions for use and operation of the appliance are not followed, there is a risk of: Burns from hot surfaces!



This symbol alerts users to the following: Failure to observe the safety instructions during use and operation of the unit may result in: Danger of fire!

Transportation/Transfer

- Transport / carry the equipment only after thorough inspection of the space and the routes, which must be unobstructed.
- Never carry the machine while it is in operation. Do not carry the device while it is plugged into a wall outlet.
- Make sure that your hands and equipment are not damp or slippery when carrying.

There is a risk of serious injury or life threatening!

There is a risk of damage to the device!

Unpack/Packaging

- Unpack and remove all parts and accessories of packaging materials and labels before putting the device into operation. Keep all packaging materials in a safe place or keep them out of the reach of children and inappropriate persons.
There is a risk of serious injury!
There is a risk of choking!

Check/Startup

- Never use the appliance if it is incomplete, damaged, or any part of it has been damaged during use. Have the appliance repaired by a specialist workshop.
There is a risk of serious injury!
- Children under 3 years of age must be prevented from accessing the appliance unless they are under the supervision.
- Children between 3 years and under 8 years of age may not connect the appliance to a power outlet, nor regulate or clean it or service the device.

Warning!

- Some parts of this product may become very hot and may cause burns. Take special care when vulnerable persons or children are present.
- The cleaning and maintenance that a user may carry out must not be carried out without supervision. Keep the iron and its power cord out of reach of children under 8 when connected to an electrical outlet or cold.
- The iron is intended for home use.
- Do not use the iron in an industrial environment or outside.
- Before connecting the iron to the wall socket, make sure that the nominal voltage indicated on the type rating plate of the iron with the voltage in your socket is the same.
- Connect the iron only to a properly grounded socket.
- Do not leave the iron unattended when connected to an electrical outlet.
- Never iron the clothes on the body.
- Do not touch the hot ironing surface. It could cause burns.
- If you have wet hands, do not touch the irons that are connected to an electrical outlet.
There is a risk of damage to equipment or other property damage!
There is a risk of electric shock! There is a risk of serious injury!
- Always disconnect the iron from the mains socket before shutting down for a short time or when it is out of use.
- Allow the ironing surface to cool before cleaning or otherwise handling the iron that you have disconnected from the mains socket.
There is a risk of damage to equipment or other property damage!
There is a risk of burning!
- The iron must not be used if it falls to the ground or it shows visible signs of damage.
- Ensure that the power cord does not come into contact with water or hot surfaces.

- Do not pull the iron out of the mains socket by pulling on the power cord. Damage to the power cord or mains socket could occur. Unplug the cable from the socket by pulling it behind the plug of the power cord.
- If the power cord is damaged, have it replaced by a specialist service center. The iron with a damaged power cord or plug of a power cord is forbidden to use.
- To avoid the risk of electric shock, do not repair the iron yourself or modify it yourself. Have all repairs carried out by an authorized service center. Interference with the product is subject to the risk of losing the statutory right from a defective performance, quality assurance.
There is a risk of damage to equipment or other property damage!
There is a risk of electric shock! There is a risk of electrical short circuit!

Location/Installation

- The iron must be used and stored on a stable surface.
- When placing the iron on the stand, make sure that the surface on which the stand is located is stable.
- Always make sure that the place where you want to place the device has enough space, stability, mechanical strength.
- Do not place the iron on an electric or gas cooker and other heat sources or near them.

Warning!

- Do not place the appliance:
 - to unstable racks,
 - to an uneven and unstable surface,
 - on a stand that is on an unstable surface.
- Do not cover the appliance in part. Do not place any objects on the device.
There is a danger of fire!

Warning!

- Place the device in a place where children can not reach freely. Prevent children from manipulating the device (played). The device may overturn and cause very serious injury. Mechanical damage (breakage of parts and covers) of the device can cause serious injury.
There is a risk of very serious injury!
There is a risk of damage to equipment or other property damage!
- The iron must not be left unattended when connected to an electrical outlet.
- Do not place or use the appliance near water containers. If the appliance falls into the water, do not remove it. First, pull the power cord plug out of the mains socket and then select the appliance from the water. In such cases, take the device for inspection to a specialist service to check that it is safe and working properly.

- There is a risk of electric shock! There is a risk of electrical short circuit!
- Always keep your device under control during use and operation!
- This device is not intended to be operated via a programmer, external time switch or remote control because there is a risk of fire if the device is covered or incorrectly positioned.
- Do not leave the appliance unattended during operation, especially if there are children, inappropriate persons or animals nearby.
- Do not use the appliance near easily flammable materials and objects, curtains, curtains, decorative fabrics, and the like.
- There is a danger of fire!
- Always connect the appliance to mains power supply for normal use, then switch on the main switch - the controller.
- When you have finished using the appliance, turn off the main switch - the controller, and then pull the power cord plug out of the mains socket.
- The machine contains parts and surfaces that are heated considerably during operation - the ironing surface.

Warning!

- After turning off the machine, the surfaces remain warm for a certain amount of time. Before any further handling of the device - cleaning and storage, always wait for the hot surfaces to cool completely.
- There is a risk of burning from the hot surface!
- The electrical socket and power cord must remain easily accessible for safe disconnection of the appliance from the power supply.
- Never leave the appliance unattended and freely accessible with a free-hanging power cord. Children, inappropriate persons or animals could download the device for the power cord.
- Do not store the appliance with a wrapped cord around your body. Unfold the network cord „in the way it was put in the original packaging by the manufacturer.
- There is a risk of serious injury!
- Children under 3 years of age must be prevented from accessing the appliance unless they are under the supervision.
- Children between 3 years and under 8 years of age may not connect the appliance to a power outlet, nor regulate or clean it or service users.

WARNING!

Some parts of this product may become very hot and may cause burns. Take special care when vulnerable persons or children are present.

Part description

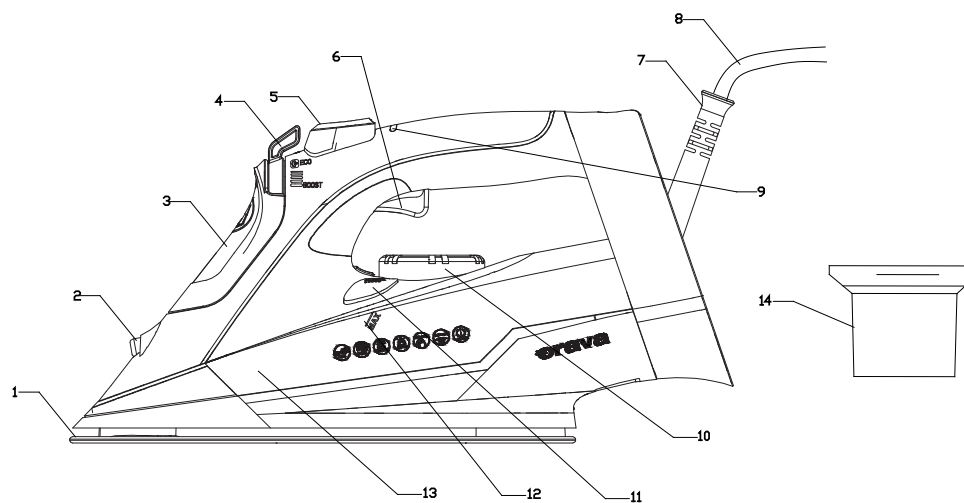

1 Ceramic soleplate

2 Nozzle

3 Water filling hole/cover

Open the cover and fill the tank with water. The volume of water must not exceed the MAX level (300 ml).

4 Steam regulator

For steam ironing turn the regulator to the right or left for the ECO. For steamless ironing, turn the regulator to the center. For maximum steam, turn the regulator all the way to the right or left to BOOST and hold.

5 Button for spraying

Pressing the button allows you to iron hard fabrics by spraying drops of water (moistening).

6 Button for turbo steam ironing - steam blast

The button allows you to iron stubborn creases and folds of the fabric through steam blasts.

7 Power cord swivel

During ironing, it protects the power cord from damage and allows the iron to move freely.

8 Power cord

9 Power/temperature light

During ironing, it lights up and goes out as the set temperature is maintained.

10 Temperature setting control

Use the knob to set the desired temperature from the minimum position (Nylon) to the maximum position (Linen).

11 Self-Clean Button

Press to perform self-cleaning

12 MAX mark

13 Water filling tank

Open the cover and fill the tank with water. The volume of water must not exceed the MAX level.

14 Water measuring cup



Operation

Before using this device for the first time

- Remove all protective foils and stickers from the ironing board.
- Heat the appliance and iron an unnecessary piece of cloth for a few minutes to remove any dirt from the ironing surface.

Preparation before ironing

- Divide the laundry according to the symbols indicated on the fabric or by the type of fabric.

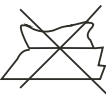
SYMBOL	TYPE OF FABRIC	SET THERMOSTAT
	synthetics (nylon, polyamide, polyester, etc.)	● low temperature
	silk - wool	● ● average temperature
	cotton	● ● ● high temperature
	flax	MAX high temperature
	Warning: This symbol means that the fabric can not be ironed!	

Fill the tank with water

- Before filling the iron with water, make sure that the iron is unplugged.
- Turn the steam control **4** all the way to the right.
- Fill the measuring cup **14** with water (max. 320 ml), open the cover for filling with water **3** and pour the water from the measuring cup into the iron, then close the cover **3**.



Warning!

Never add water softeners or various fragrance mixtures to the water.

Temperature setting

- Place the iron vertically on a flat and stable surface.
- Connect the power cord **8** to the socket.
- Use the temperature control **10** to set the temperature according to the fabric. The orange indicator light **9** lights up. When the desired temperature is reached, the indicator lights up green. Start ironing.

Steaming

- If you want to iron with steam, the water tank **13** must be filled with water and the temperature must be set to ••• to MAX.
- Move the steam control **4**  to the right or left to increase the steam output and vice versa. Set the steam control **4**  to the middle to switch off steaming.

Steam impact

- Press the steam boost button **6** to generate a strong stream of steam that straightens stubborn creases and folds in the fabric.
- If steam blasts are to be used, the water tank **13** must be filled with water and the temperature must be set to ••• to MAX. If the control indicator **9** lights up, wait until it goes out before pressing button **6** again.
- Wait at least 5 seconds before using the steam boost again.
- You can also use the steam boost in a vertical position (eg on curtains, hanging clothes, etc.).

Sprinkling (spraying)

- You can use water sprinkling at any ironing temperature.
- If you want to iron with steam, the water tank **13** must be filled with water.
- To sprinkle the fabric from nozzle **2**, press button **5**. If you are using sprinkling for the first time or have not used sprinkling for a long time, press button **5** several times until nozzle **2** starts working properly.

Note

We do not recommend using sprinkling on silk and synthetic fabrics.

Anti-drip system

- The Anti-drip system (or also Drip Stop) function prevents liquids from dripping, which occurs with steam irons when ironing at a lower temperature. This function stops the generation of steam at a lower temperature, thus preventing liquid from flowing out of the ironing surface.

Anti-calc system

- The appliance is equipped with a permanent Anti-Calc filter, which reduces the formation of calcium deposits inside the iron. This filter cannot be selected. The effectiveness of the filter depends on the hardness of the water you use.

Auto-shut off function

- The iron switches off automatically if you leave it for 8 minutes without moving when it is in a vertical position, or after 30 seconds without moving it in a horizontal position. The device beeps and flashes to indicate that it is switching off automatically.
- When you want to switch the iron on again, just move the iron. The green auto power off light turns off. The red temperature light comes on. When the red temperature light goes out and comes on again, the iron is ready for reuse.

Warning!

- Although the iron is equipped with an automatic shut - off function, for safety reasons, never leave it unattended when it is connected to the mains.

Tips for ironing

- Always check the label on the ironing cloth, which also contains ironing instructions. Always follow these guidelines.
- The iron heats up faster than it cools. Therefore, start by ironing textiles requiring lower ironing temperatures that contain synthetic fabrics.
- If textiles contain different types of fibers, always set the ironing temperature according to the fibers that are most sensitive to temperature.
- Silk and other glossy textiles iron on the opposite side. To avoid it to damage, ironing silk and other fine textiles do not use spraying.
- Warm it and similar fine fiber fabrics iron it in just one direction. Apply gentle pressure and always follow the movement of the iron.

Cleaning and maintenance

Calcium scale removal (Self-clean)

- The iron is equipped with a Self-clean system to remove deposits. Use the Self-Clean system at least once a month.
1. Fill the water tank with water up to the MAX mark. Set steam control **4** to minimum.
 2. Set the temperature control **10** to the maximum and wait until the indicator light **9** goes out.
 3. Unplug the iron and hold it horizontally above the sink.
 4. Press and hold the Self-clean button **11**. Steam will start to come out of the soleplate and water will drip.
 5. Carefully move the iron from left to right until the entire contents of the water tank are empty.
 6. Release the Self-clean button **11**, let the iron cool down and then dry the ironing surface **1** with a clean cloth

After ironing

1. Set the temperature control to the off position, unplug the power cord and let the iron cool down completely.
2. Clean the soleplate and the surface of the appliance. Use only a slightly damp cloth for cleaning.
Do not use any solvents or harsh cleaners.
3. Wrap the power cord in the designated area and secure it with a clip.
4. Store the iron in a horizontal position in a stable and safe place and protect the ironing surface with a cloth.

Technical specifications

Power supply:	230 V~ 50 Hz
Power consumption:	2 600 W
Protection class:	I
Continuous steam output:	40 g/min.
Steam impact:	180 g/min.
Water tank capacity:	320 ml
Power cable length:	2,5 m
Hmotnost:	1,38 kg
Dimensions (W x H x D):	31,1 x 15,5 x 13,3 cm

We reserve the right to make changes!

Producer:

ORAVA retail 1, a.s.
Seberínho 2
821 03 Bratislava
Slovenská republika

Importer:

ORAVA retail 1, a.s.
Seberínho 2
821 03 Bratislava
Slovenská republika

ORAVA distribution CZ, s.r.o.
Ostravská 494
739 25 Sviadnov
Česká republika

INSTRUCTIONS AND INFORMATION REGARDING THE DISPOSAL OF USED PACKAGING

Dispose of used packaging material at a municipal waste disposal site.

DISPOSAL OF USED ELECTRICAL AND ELECTRONIC EQUIPMENT

This symbol on the products or in the accompanying documents means that used electrical and electronic products should not be mixed with general household waste. For proper disposal, recovery and recycling, please return these products to designated collection points. Alternatively, in some countries of the European Union or other European countries, you may return your products to your local retailer when purchasing an equivalent new product. By ensuring this product is disposed of correctly, you will help prevent potential negative consequences for the environment natural resources and help prevent potential negative effects on environment and human health, which could be the consequences of improper disposal waste. Contact your local authority or nearest office for more details collection point. Improper disposal of this type of waste may result in penalties in accordance with national regulations.

For business entities in the countries of the European Union

If you wish to discard electrical and electronic equipment, please request the necessary information from your seller or supplier.

Disposal in other countries outside the European Union

This symbol is valid in the European Union. If you wish to discard this product, please request obtain the necessary information on the correct method of disposal from the local authorities or from the your supplier.



This product complies with all the essential requirements of the EU directives that apply to it.