

Electric heated overblanket

orava

EB-160A

Instruction manual

EN



Keep these instructions for future use

CE

EB-160A

Intended use of the device

The device, comprising a flexible part with a heating element and all other current-carrying parts, is intended exclusively to create the thermal comfort of the human body in the home environment, to the extent specified by technical and operational parameters and functions, safety and user instructions and external effects of the operating environment.

Such an electrical appliance may be:

- blanket - is designed to warm and cover the user's body
- pad - is designed for heating and use under the user's body
- pillow - is designed to heat a part of the human body
- quilt - is a quilted blanket intended for use without further covering of the user
- mattress - is an appliance that contains an upholstered flexible part and which is designed to heat the user's bed

This appliance is not intended for medical use in hospitals and other healthcare facilities. ORAVA electrical appliances are manufactured according to the knowledge of the current state of technology and recognized safety and technical rules. Nevertheless, incorrect and unprofessional use or use contrary to the intended purpose may create a risk of injury or endanger the life of the user or a third party, resp. damage to equipment and other property.

1. GENERAL SAFETY INSTRUCTIONS AND WARNINGS

- This document contains important safety instructions and warnings for safe, correct and economical operation of the electrical equipment. Its compliance helps the user avoid risks, increase reliability and product life.
- In this document, the general term product is used in text parts such as: electrical equipment - any device used for the production, conversion, transmission, distribution or use of electricity.
- From the point of view of the purpose of using electricity, the concept of electrical equipment in the strict sense of the word will include the following categories:
 - household electric appliances,
 - information and communication equipment,
 - consumer electronics,
 - lighting equipment,
 - electrical and electronic tools,
 - toys and equipment for sporting and recreational purposes,
 - medical devices (aids),
 - monitoring and control devices,
 - vending machines.

1.1 General safety instructions

- Before operating the unit, we recommend that you carefully read the instruction manual and operate the equipment in accordance with the instructions!
- The safety instructions and warnings in this manual do not cover all the possible conditions and situations that may arise when using the device. The user must understand that a factor that cannot be incorporated into any of the products is personal responsibility and caution. These factors must therefore be ensured by users serving this device.
- Failure to follow the safety instructions and warnings is forbidden by the manufacturer for any damage to health or property!
- Keep the instruction manual as close to the device as possible throughout its service life. Always keep the instruction manual together with the appliance for future use and use by new users.
- Use the appliance only for the intended purpose and in the manner specified by the manufacturer.
- The appliance is intended for home and similar indoor use without special focus.
- This appliance is intended, in addition to domestic use, for the following uses:
 - in shops, offices and other similar work environments;
 - in economic buildings;
 - in hotels, motels and other residential environments;
 - in bed and breakfast establishments.
- It is not a professional device for commercial use.
- Do not change the technical parameters and features of the device by unauthorized modification or modification of any part of the device.
- The manufacturer is not responsible for damages caused during transportation, misuse, damage or destruction of the equipment due to adverse weather conditions.

1.2 Safety of the operating environment

- Do not use the device in an industrial environment or outside environment!
- Do not expose the appliance to:
 - sources of excessive heat or open flame,
 - dripping or splashing water,
 - vibration and excessive mechanical stress,
 - insects, animals and plants,
 - aggressive and chemical substances.
- The operating environment of the device must always be in accordance with the basic characteristics set out.

- Features of the operating environment:
 1. Ambient temperature: $+5 \div +40$ ° C
 2. Humidity: $5 \div 85\%$
 3. Altitude: $\leq 2\,000$ m
 4. Occurrence of water: intermittent condensation of water or occurrence of water vapor
 5. Occurrence of foreign bodies: quantity and type of dust are insignificant
 6. Protection degree: min. IP20 (device protected from touching dangerous parts by hand and non-waterproof)
- This degree of protection is not indicated on the product and on the technical parameters in the operating instructions.
- If the protection class of the product is different from IPX0, this information is then displayed on the label of the appliance or in the technical data of the operating instructions.
- Other characteristics of the domestic operating environment (mechanical stress - vibrations and vibrations, occurrence of plant, animals, weather effects ...) are negligible in terms of effect on the correct and safe use of electrical equipment.

1.3 Electrical safety

- Before connecting the appliance to the power supply for the first time, make sure that the voltage on the appliance label corresponds to that of the household electrical outlet.
- The electric appliance is designed to power from 1 / N / PE ~ 230 V 50 Hz.
- The electrical safety of the appliance is guaranteed only if it is properly connected to the mains.
- Electrical protection class I equipment is equipped with a protection against electric shock by means of protective earthing of inanimate parts, which can become dangerous when the device is malfunctioning. Always connect such devices to properly installed mains sockets that are equipped with earthing conductors and have a properly grounded earthing conductor.
All electrical equipment is equipped with a three-wire power supply.
- Class II electrical equipment is protected against electric shock by double insulation or by enhanced insulation of hazardous live electrical parts. Device of protection class II it must not be equipped with means to connect protective earthing.
All electrical equipment is equipped with two-wire power supply.
- Class III electrical equipment is a device that is powered by a small safe voltage source (battery or accumulator) and does not present any danger to the user from electrical shock.
- In order to provide increased safety against the risk of electric shock due to the use of electrical appliances by laypersons, it is recommended to install the power supply circuit for sockets with a rated current not exceeding 20 A RCD with a rated operating current not exceeding 30 mA.
To ensure the safety and correctness of the electrical installation, consult a qualified electrician.

- Only use a power cord with a plug (mains lead) supplied with the device and compatible with a wall socket. Using another cable may result in fire or electric shock.
- Always connect an electrical appliance to an easily accessible mains socket. In the event of an operating fault, the appliance must be switched off as soon as possible and disconnected from mains supply.
- The power cord and mains plug must always be easily accessible for safe disconnection of the electrical appliance from the power supply.
- Do not pull off the power cord by pulling the cable. Disconnect the power cord by pulling the plug behind the power cord plug.
- If you use an extension cord, make sure that the total rated power of all devices connected to the extension cord does not exceed the max. current load on the extension cable.
- If you need to use an extension cord or power supply block, make sure that the extension cord or power pack is plugged into a power socket, and not to another extension cord or power supply. The extension power cord or power supply block must be designed for grounded electrical plugs and connected to a properly grounded electrical socket.
- The power plug of the appliance must be compatible with the mains socket. Never use any adapters or modify the socket in any other way. Do not use inappropriate or damaged drawers!
- To avoid electrical shock, plug the power cables into properly grounded electrical sockets. If the device is equipped with a 3-pole plug, do not use adapters that do not have a grounding element or remove the grounding element from the plug or adapter.
- Do not bend, crush or otherwise expose the power cord of the appliance to mechanical stress or external heat sources. Damage to the power cord may result in electric shock.
- When the power cord is damaged, disconnect the appliance from the mains and do not use it again.
- If the power cord is damaged, it must be replaced by the manufacturer, its service department or a similarly qualified person to avoid the risk of electric shock.
- Regularly check and maintain the electrical appliance as well as the power cord and power socket. Disconnect the power plug regularly and clean it if necessary. Pollution by dust or other substances may cause disruption of the insulating state and consequently fire.
- Do not expose the appliance to water or moisture. The ingress of water into the appliance increases the risk of electric shock.
If the power cord is wet or the water has penetrated the water, disconnect it immediately from the mains. If the appliance is plugged into a mains socket and if possible, turn off the power circuit before attempting
unplug the power. If you are pulling wet wires from a live power source, be very careful.
- If the electrical equipment is installed (connecting) the protective covers are dismantled, the electrical parts must not be accessible to the user when the installation is finished.

1.4 Safety of persons

- This appliance is intended for use and operation by persons without electrotechnical qualification - lay people, according to the instructions specified by the manufacturer.
- Device operation includes activities such as switching on and off, user manipulation and setting of operating parameters, visual or auditory inspection of the equipment, and user cleaning and maintenance.
- This appliance can be used by children under the age of 8 and persons with reduced physical, sensory or mental capabilities or lack of experience or knowledge when supervised or instructed to use the appliance safely and understand the dangers involved.
- Children may not play with the appliance.
- Cleaning and maintenance for users may not be performed by children unattended.
- Always keep the appliance out of reach of children during use and operation. Be sure to download the appliance even for a freely accessible power cord.
- Always be careful when operating the electric appliance! Do not use an electric appliance if you are overly tired, under the influence of medication or narcotic drugs that reduce attention and focus.
- Inattention during operation may result in serious injury.

1.5 Cleaning, maintenance and repairs

- Observe the normal user cleaning and maintenance of the appliance in the recommended way. Do not use solvents or harsh cleaners for cleaning. Pollution and visible stains from finger contact, respectively. The hands can be cleaned using detergent detergents specially designed to clean household appliances.
- If you do not use the appliance, clean it or disconnect the appliance from the power supply when the appliance is faulty.
- Electrical appliances that are cleaned after use and are not intended to be completely or partly immersed in water or other liquid, protect against the effects of dripping and / or splashing water and before immersion.
- Electric household appliances, like all other technical devices, are subject to the surrounding environment and natural wear. Since the legal framework of regular maintenance is not laid down for lay-in electrical household appliances, the manufacturer recommends that the user have the appliance checked and cleaned at least once a year by a specialist workshop.
- By doing so, it is possible to achieve safety, operational reliability and increased service life.
- Do not disassemble the electric appliance! The appliance works with a dangerous voltage. For this reason, always switch off the appliance and disconnect it from the mains supply during user maintenance. In the event of a fault, please have the repair serviced by an authorized service center.
- Before calling a service:
 1. Turn the appliance off and on to make sure the fault reappears.
 2. If the malfunction of the appliance still persists after these operations, call the nearest specialist service center.
- Never repair the electric appliance yourself!
- Unauthorized, unqualified and improper use of an electric appliance may result in electric shock or other serious injury.
- Only carry out the warranty or post-warranty repair of an electrical appliance to an authorized qualified person (*).

(*) Competent qualified expert: the sales department of the manufacturer or importer or the person qualified and authorized to carry out this type of activity with the ability to avoid all risks.

Important instructions. Save for future use.

Special safety instructions.

- The electrical equipment is designed and manufactured in the way that allow safe operation and use by persons without professional qualifications. Despite all the measures taken by the manufacturer for safe use, operation and use carry certain residual risks and the possible dangers associated with them.
- The following symbols and their meanings have been used on the device and in the accompanying documentation to warn of possible dangers:



This symbol on the product warns the users of the product to be well informed with all the information given in the instruction manual and especially with the contents and instructions that draw attention to safety in the operation and use of the product.



This symbol alerts users that the device is operating with dangerous electrical voltage. Do not remove the protective covers from the device.

Failure to observe the safety instructions for the use and operation of the device may result in:

Danger of electric shock! Danger of serious injury or death!



This symbol alerts users to the fact that if the safety instructions for use and operation of the device are not observed, there is a risk of:

Danger of serious injury or death! Danger of equipment damage or other property damage!



This symbol means that the product is made with double insulation between dangerous live parts (parts with dangerous mains voltage) and parts that are accessible during normal use.



This symbol indicates that the product is only functionally grounded. Such electrical equipment, which contains only functional earthing, does not contain any protective earthing means that would be connected to the protective earthing system of the fixed electrical installation, to provide protection against dangerous contact voltage by automatic (automatic) disconnection from the power supply.



This symbol on the product indicates to users that during use of the product during its operational activity as well as throughout the operational life of the product, they shall comply with the requirement:

The product is not intended for use by very young children (up to 3 years of age).



The symbol indicates to users that during use of the operational activity with the product and as well as throughout the operational life of the product, they shall comply with the requirement:

Do not push pins or any other objects into the blanket (pads, pillows, quilts, mattresses ...).



The symbol on the product indicates to users that during use of the product during its operational activity as well as throughout the operational life of the product, they shall comply with the requirement:

Do not use the product (its flexible parts) folded over several layers or creased.

This symbol applies only to a product that is a pad other than that having a heating element with PTC properties (a heating element consisting of a pair of conductors separated by a conductive material that has a rapid non-linear increase in resistance if the temperature rises above a certain range).

For the cleaning of flexible parts of the product, certain recommendations are prescribed, as well as certain restrictions, which are important for maintaining the required user properties, safety and expected life of the product.



The product may only be washed by hand at a maximum water temperature of 40 ° C.



The product may be washed in an automatic washing machine at a maximum water temperature of 40 ° C and significantly limited mechanical action. Normal rinsing and slight spin. Normal rinsing and slight spin.



The product may be washed in an automatic washing machine at a maximum water temperature of 30 ° C and significantly limited mechanical action (fine laundry).



The product must not be washed. If the product is wet, very careful handling is recommended.



After removing the excess water (by centrifugation), the washed item is placed spread out on a suitable mat (eg a clothes dryer or over several cords next to each other) and allowed to air dry. It is not recommended to dry the product after washing by hanging (folding) on one cord to avoid excessive stress on the hot water conductors under the weight of the fabric.



The product must not be tumble dried.



The product must not be chemically cleaned. Stains on the product must not be removed with organic solvents.



The product must not be bleached with chlorine-releasing agents.



The product must not be ironed. Steaming and steaming are not allowed.

Transport/Carrying

- When transporting and carrying, be careful when moving to avoid damaging the device.
Danger of damaging the device!

Unpacking/Packaging

- Unpack the device and accessories before using and dispose of all parts of the packaging materials, labels and tags. Keep packaging materials in a safe place or keep them out of the reach of children and incompetent persons.
Danger of serious injuries! Danger of suffocation!

Inspection/Commissioning

- We recommend performing initial and subsequent regular inspections of the device.
- Never use the device if it is incomplete, damaged or any part of it has been damaged during use.
- Do not use incomplete equipment, non-original parts, components and accessories.
- If the appliance shows any signs of damage or other signs that could lead to incorrect use before putting it into operation, return it to the manufacturer before switching it on.
- Never clean the appliance (its electrical control unit) and the mains cord with a plug in such a way that liquid could leak into the appliance. Clean these parts only with a damp cloth and wipe dry or allow to dry.
- Only clean the appliance when it is switched off and unplugged.

Location/Installation

Warning!

- The appliance should not be used on beds or other adjustable bed or seating devices, as the power cord may be caught in the movable hinges intended to change the position setting and create a dangerous situation.
- If the appliance is used on an adjustable bed or seat, always check that the power cord or the appliance itself (its flexible part) has not been caught or bent, for example in the positioning hinges, before using it.
- Do not use or place the device:
 - on a contaminated surface,
 - near containers with water or other liquids

Warning!

- Place the appliance in a place where children cannot reach freely. Mechanical damage (cracking or breaking of parts and covers) of the device can cause serious injuries and a dangerous situation. Danger of serious injuries!
There is a risk of damage to the device or other property damage!
- Do not place or use the device near containers containing water. Do not remove the device if it falls into the water. First pull the mains plug out of the mains socket and only then remove the appliance from the water. In such cases, take the device to a specialist garage for inspection to ensure that it is safe and working properly.
There is a risk of electric shock! Danger of electrical short circuit!

Storage

When the appliance is not in use, store it as follows:

- Always allow the appliance to cool down thoroughly after use.
- Store the appliance so that there are no folds or creases on the flexible parts.
- Store the appliance in the manner recommended by the manufacturer to prevent excessive mechanical wear and possible damage due to improper folding and creasing. By folding the appliance correctly and gently, you can make a significant contribution to achieving the optimum service life of the appliance.
- When storing the appliance, do not place other objects on it that may cause the flexible part to wrinkle improperly or may mechanically damage the electrical connections and electronic control circuits.

Operation/Supervision

Warning!

- Due to the nature and purpose of the use of the electrothermal appliance, the manufacturer recommends that persons with a pacemaker or similar device containing sensitive electronics be informed of the possible adverse effects before using the appliance.
- The device is not suitable for use by highly vulnerable persons (persons with extensive and complex disabilities) who are unable to respond to overheating (eg diabetics, persons with skin changes due to illness, or persons under the influence of sedatives or alcohol).
- The appliance is not suitable for use by helpless persons and must not be used by very young children.
- Do not use the device if your body has e.g. inflammatory skin disease or disease accompanied by a swelling condition.
- Do not use the appliance during sleep or if you are very drowsy.
- Always consult your doctor to ensure safe use of the device.

Warning!

- The electric flexible heat appliance is equipped with an electronic control unit that ensures correct and safe operation during normal use.
- Use the flexible part of the electrothermal appliance only with the specified type (or types) of control unit or detachable transformer, which is specified by the appliance manufacturer for correct and safe use.
- Any other type of control unit can cause incorrect regulation, overheating of the appliance and risk of fire.

Warning!

- The product frequently and thoroughly checks for signs of wear or damage.
- If you require similar signs, or if the product is used in the wrong way or does not work, send it to a specialist for inspection before switching it on again.
- Keep the device under supervision during use and operation!
- This device is not intended to be operated by programmer, external timer or remote control, as there is a risk of fire if stored incorrectly.

Warning!

- The device must not be left unattended while it is connected to the electricity.
There is a risk of electric shock!
- Before each connection of the device to the electricity, make sure that the control knob is in the „0“ (off) position.
- Do not turn the machine on or off by plugging or unplugging the power cord.
- In normal use, always connect the appliance to the mains socket first and then switch it on with the control knob (main switch).
- When you have finished using the appliance, switch it off and then unplug it.
- Do not use the device if the control controller (main switch) does not work on the device.
- The device is under dangerous voltage when the mains supply is connected.
There is a risk of electric shock! Danger of serious injuries!
- The device contains parts that become hot during operation.
- After turning off the unit, the heated parts remain warm for some time. Before any further manipulation of the device - storage, resp. storage, always wait until the appliance has cooled down completely.

- Never leave the device freely accessible and do not store it with a freely accessible power cord.
Danger of serious injuries!
- Never overload the device above the limits set by the technical parameters!
- Always divide the operating mode (operating / operating time and breaks) of the device into the recommended operating intervals and follow these instructions.
- If you notice any abnormalities (smell, smoke ...) while using the appliance, switch off the appliance immediately and disconnect it from the mains. Have the device checked by a specialist garage.
- Only fold and unfold the individual parts, clean and carry the device if the device is switched off, sufficiently cool and disconnected from the mains.

Warning!

- The electrical appliance can be equipped (depending on the type and purpose) with an inseparable power cord and an electronic control unit. When cleaning the appliance, always take extra care to prevent water from entering the switch and / or regulator of the control unit.
- Only clean the appliance with an inseparable power cord with a damp cloth or sponge.
- Do not use the appliance when it is damp or wet. In this case, let it dry thoroughly in a suitable place and in a developed and straightened state.
- If any safety part / component (mechanical, electrical) is part of the device, never deactivate this part / component! Do not use the device if the safety part / component is damaged or non-functional!
- Never underestimate the possible dangers and pay attention to the increased caution !!!

Information

The device is designed to heat the body. It is used as a covering and wrapping blanket, not as a base blanket. Don't lie on it!

Proper use results in an increase in blood circulation in the skin, which is reflected in a pleasant and long-lasting feeling of warmth (increase in skin temperature).

The blanket generates warmth that will provide a pleasant and relaxing rest. It's a great way to get rid of stress.

A special safety circuit takes care of the automatic temperature control.

The device has protection against overheating.

The synthetic wool material is soft and can be washed in an automatic washing machine.

Description of parts

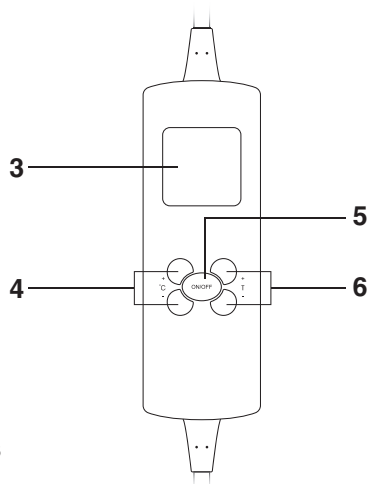
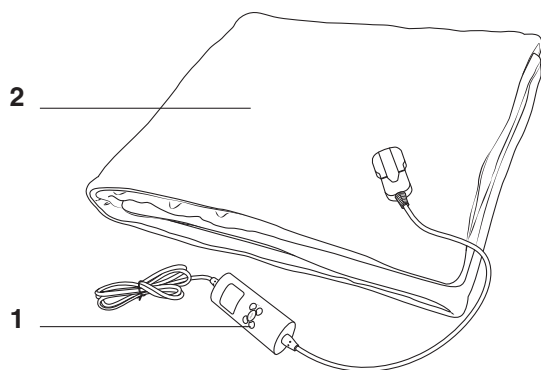

- 1 Controller**
- 2 Blanket**
- 3 Display**
- 4 Temperature setting button - 6 degrees**
- 5 ON/OFF button**
- 6 Time setting button - max. 3 hours**

Preparation

Location

Unroll the heating blanket where you want to use it, making sure that it is not bent and that the control power cord is closer to your head at the top. Check that the heating blanket is properly straightened. Each time you use the heating blanket, please make sure that it is properly spread out and straightened.

Using the device

- 1 Plug the power cord into an electrical outlet.
- 2 Press the **4 (° C) + or -** buttons to set the temperature so that 1, 2, 3, 4, 5 and 6 light up in sequence one after the other.
When switched on to level 6, the blanket is heated to 40 °. When the blanket is warm enough, cover it and slide the temperature switch to switch the heating to a lower level that suits you.

Description of button operation:

Button for setting the temperature

Display	Power	approx. °C	Heating
1	25 %	28 (± 5°)	very weak
2	40 %	30 (± 5°)	weak
3	55 %	32 (± 5°)	medium
4	70 %	34 (± 5°)	medium strong
5	80 %	36 (± 5°)	strong
6	100 %	40 (± 5°)	very strong

The stated temperatures in ° C are informative. The temperature is affected by the environment where the heating blanket is used.

- 2** Press the **6 (T) + or -** buttons to set the time so that 1, 2 and 3 light up in sequence.

Time setting button

Display

1

2

3

Switch - on time

LED for 1h

LED for 2h

LED for 3h

1 hour

2 hours

3 hours

Notifications!

- If the heating blanket is switched on, its control may be slightly heated, so it must not be covered during use.

- You should not test the temperature of the heating blanket with your hands, as they are less sensitive than the surface of your body. The temperature detected by the hand seems lower and could have an unpleasant effect on other parts of your body.

- 3** After use, switch off the heating blanket with the on / off switch and store it after it has cooled down.

Cleaning and maintenance

Before cleaning, unplug the appliance and let it cool down!

You can remove small dirt with a cloth or a damp sponge soaked in lukewarm water. You can remove larger soils by washing. Always unplug the remote control before washing!

Do not use chemical cleaners, thinners, solvents or benzine.

Washing process:

- 1 Disconnect the blanket from the power cord first.

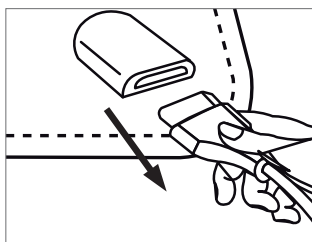

To disconnect the connector, lift the locking latch with your finger and pull the connector straight out. Do not pull the connector cable and do not try to pull out the connector without lifting the fuse, otherwise the socket may be damaged.

- 2 Wash by hand or washing machine at a temperature of max. 28 ° C.
- 3 After washing the blanket, rinse thoroughly in lukewarm water.
- 4 Do not squeeze the heating blanket or use the tumble dryer to dry.
- 5 Spread the blanket loosely on the clothes dryer and let it dry naturally.

Notifications!

- Never wash the heating blanket together with the power cord!
- Do not use hair dryers or other appliances for drying, allow the blanket to air dry.
- Never switch on the heating blanket to dry it!

Storage

Unplug the appliance. Make sure it is thoroughly cooled and dry. Then store it in a clean and dry place, preferably in the supplied PVC packaging.

Technical specifications

Power supply:	220 - 240 V~ 50/60 Hz
Power consumption:	85 W
Dimensions:	160 x 130 cm
Weight:	1,5 kg

Producer:

ORAVA retail 1, a.s.
Seberíniho 2
821 03 Bratislava
Slovenská republika

Importer:

ORAVA retail 1, a.s.
Seberíniho 2
821 03 Bratislava
Slovenská republika

ORAVA distribution CZ, s.r.o.
Ostravská 494
739 25 Sviadnov
Česká republika



DISPOSAL OF USED ELECTRICAL AND ELECTRONIC EQUIPMENT

The symbol on the product or on its packaging indicates that this product does not belong to household waste. It is necessary to take it to a collection point for electrical recycling and electronic equipment.

By ensuring proper disposal of this product, you will help prevent negative consequences to the environment and human health that would otherwise be caused by inappropriate disposal of this product. For more detailed information about recycling of this product, please contact your local authority, your household waste disposal service or the shop where you purchased the product.



This product meets all the essential requirements of the EU directives that apply to it.