

Electronic kitchen scale

orava

EV-14

Instruction manual

EN



CE

Model: EV-14

Intended use of the device

- The equipment is intended solely for determining the weight of food and other small items in the household, to the extent determined by technical and operational parameters and functions, safety and user instructions, and external influences of the operating environment.
- The scale may not be used for weighting in business relationships, for calculating fees and penalties and similar types of payments, in the judiciary, in health care, in pharmaceutical laboratories, for pricing and for other purposes specified under Directive of the European Parliament and of the Council 2014/31/EU on the harmonization of the laws of the Member States relating to the making available on the market of non-automatic weighing instruments.
- ORAVA electrical appliances are manufactured according to state-of-the-art knowledge and recognized safety regulations. Nevertheless, improper or improper use or improper use may result in injury or endangerment to the life of the user or a third party or to a third party. damage to equipment and other property.

1. GENERAL SAFETY INSTRUCTIONS AND WARNINGS

This document contains important safety instructions and warnings for the safe, correct and economical operation of electrical/electronic equipment. Its compliance helps the user avoid risks, increase product reliability and durability.

1.1 General safety instructions

- We recommend that you carefully read the operating instructions before operating the unit and operate the unit in accordance with the instructions!
- The safety instructions and cautions in this manual do not cover all possible conditions and situations that may occur when using the machine. The user must understand that a factor that cannot be built into any of the products is personal responsibility and caution. These factors must therefore be ensured by the users operating the device.
- The manufacturer is not responsible for any damage to health or property if the safety instructions and warnings are not followed!
- Remove all packing material and labels from the machine before using the machine for the first time. Secure and keep the packaging material out of the reach of children and incapacitated persons.
- Before using the machine for the first time, make sure that the machine is complete and shows no visible signs of damage. Do not use the product if it is defective or has any visible damage.
- If possible, keep the operating instructions close to the unit for the entire life of the unit. Always keep this manual with your device for future reference and use by new users.
- Do not alter the specifications and characteristics of the equipment by unauthorized modification or modification of any part of the equipment.
- The manufacturer is not liable for damage caused during transport, misuse, damage or destruction of the device due to adverse weather conditions.
- Use the device exclusively for its intended purpose and in the manner specified by the manufacturer

1.2 Safety of the operating environment

- Do not use the device in an industrial or outdoor environment!
- Operating environment characteristics
 1. Ambient temperature: $+5 \div +40$ ° C
 2. Humidity: $5 \div 85\%$
 3. Altitude: $\leq 2\,000$ m
 4. Occurrence of water: occasional occurrence of water vapor
- Other characteristics are determined according to the data on the label and in the section „Technical data“ of the operating instructions.

1.3 Electrical safety

- This device is designed exclusively for operation with a safe low voltage - primary battery.
- The device operates at a safe low voltage, so there is no risk of electric shock when used and operated under reasonably foreseeable conditions.

1.4 Safety of persons

- This equipment is designed for use by non-professional personnel according to the manufacturer's instructions.
- Operations of the equipment include operations such as turning the equipment on and off, user handling and operating parameter settings, visual or audible inspection of the equipment, and user cleaning and maintenance.
- This device may be used by children from 3 years of age and persons with reduced physical, sensory or mental abilities or lack of experience or knowledge when supervised or instructed in the safe use of the equipment and understand the dangers involved.
- Children must not play with the device.
- Cleaning and maintenance by the user must not be performed by children without supervision.

1.5 Cleaning, maintenance and repair

- Perform routine user cleaning and maintenance only as recommended. Do not use solvents or abrasive cleaners or items for cleaning. Contamination and visible stains from the touch of fingers or fingers. hands can be cleaned using detergents specially designed for cleaning household appliances and consumer electronics, respectively. equipment installed inside the vehicle.
- Never repair the unit yourself!
- Have the product serviced by a qualified person only (*) for both warranty and post-warranty repairs.

(*) Competent qualified professional: the sales department of the manufacturer or importer or a person who is qualified and authorized to carry out this type of activity with the ability to avoid all hazards.

2. SPECIAL SAFETY INSTRUCTIONS

- Electrical equipment is designed and manufactured in such a way as to allow safe operation and use by unauthorized personnel. Despite all precautions taken by the manufacturer for safe use, operation and use entails certain residual risks and the associated potential hazards.
- The following symbols and their meanings have been used on the device and in the accompanying documentation to indicate potential hazards:



This symbol warns the user that if the safety instructions for using and operating the device are not followed, there is a danger:
Serious injury!
Risk of equipment damage or other property damage!

Transportation/Transfer

- During transport and use, take care when moving the truck to prevent the machine from toppling over.
- Only transport/carry the equipment after thoroughly inspecting the area and routes, which must be clear of obstructions.
- Never carry the machine while it is in operation. Do not carry the device while it is connected to a power outlet.
- Carry the machine by firmly gripping the bottom edge of the base or solid body parts. When carrying, ensure that your hands and equipment are not damp or slippery.
Risk of serious injury or death!
Risk of equipment damage!

Unpack/Packaging

- Unpack the device (and accessories, if equipped) before putting it into operation and dispose of all parts of the packaging material, labels and labels. Store packaging materials in a safe place, especially out of the reach of children and incapacitated persons, or dispose of them safely.
- Clean the machine as described in section before commissioning „Cleaning and maintenance“.
- Never clean the device (its parts with electronics) in a way that could cause the cleaning liquid to flow into the device. Clean these parts only with a slightly damp cloth and wipe them dry or allow to dry.
- Do not immerse the device in water or other liquids. Risk of equipment damage!

Inspection/Commissioning

- We recommend performing initial and subsequent regular inspections of the equipment.
- Never use the appliance if it is incomplete, damaged or any part of it has been damaged during use.
- Do not use non-original and incomplete parts and accessories. Risk of serious injury!
- If the device has been transported and stored at low temperatures or excessive humidity (eg in winter), first allow it to “acclimatize” at room temperature for about, to 1 hour, eliminating any moisture in the electronic parts that occurs when the temperature changes environment.
Risk of equipment damage!

Location/Installation

- Only place the device on:
 - flat, firm and stable supports - for tables and furniture parts intended for use with kitchen appliances.
- Always make sure that the area where you want to place the machine has sufficient space, mechanical strength and load capacity.

Warning!

- Do not place the device:
 - uneven, unstable and contaminated surfaces,
 - on the tight edge of tables, tables or furniture parts,
 - in the vicinity of containers containing water or other liquids.
- Do not expose the device to:
 - direct sunlight and equipment producing excessive heat,
 - sudden and significant change in ambient temperature,
 - vibration and mechanical stresses,
 - excessive dust,
 - water and excessive moisture,
 - insect,
 - aggressive external environment.

Warning!

- Place the device in a place where children cannot reach freely.
- Keep children away from the device. The device may topple over and cause injury to children.
- Mechanical damage (eg rupture of plastic covers) of the device can cause serious injury.
Risk of serious injury!
There is a risk of damage to the equipment or other property damage!

Operation/Supervision

- For correct and reliable operation of an electronic device that has been stored at low temperatures and excessive humidity (eg in winter), allow the device to acclimatise first.
- Use the machine horizontally and on a firm surface. An uneven, unstable or soft mat may adversely affect the accuracy of the weight measurement results.
- Do not use the device near strong electromagnetic fields. Strong effect electromagnetic field may affect the correct functioning of the electronic device.
- Do not use the machine near containers containing water. If the device fall into the water, take it to a specialist garage to check that it is safe and working properly.
- Store the device in a clean, dry place. Do not load the device when storing.

- Never overload the device beyond the limits specified in the technical data!
- If the device shows abnormal symptoms, have the device checked by a specialist garage.
- If any safety part (mechanical, electrical/electronic) is part of the device, never put it out of operation! Do not use the appliance if the safety part/component is damaged or malfunctioning!
- Never underestimate possible dangers and be careful !!!

Power Supplies/Batteries

Safety instructions for replacing and disposing of the power supply - batteries:

Warning!

- When using electrical/electronic equipment that is equipped with a DC power supply - battery or accumulator, always observe the important safety instructions and cautions when operating and handling these sources.

Warning!

- Never recharge batteries!
- Never disassemble batteries!
- Never heat batteries into a fire! Failure to observe the safety instructions could result in: Risk of serious injury!
Danger of explosion! Chemical hazard!
Risk of damage to equipment or other property damage!

Warning!

- The device is equipped with a power source that can be replaced by users - batteries.
- Danger of electric shock, explosion, electrolyte leakage, burns may result from improper replacement and handling.
- Dispose of batteries according to the applicable regulations and regulations for the disposal of electronic devices.

Warning!

- Always store batteries out of reach of children, incapacitated persons and pets.
- Store used batteries carefully to prevent children from swallowing them, and dispose of them as soon as possible. If swallowed, seek medical advice immediately.
- Use only the same or equivalent type of batteries specified by the manufacturer. Do not use new batteries with old ones. This may damage the device.
- Wipe the batteries with a dry cloth before inserting them. This ensures better electrical contact
- Insert the batteries to match the “+” and “-” symbols on the batteries and on the inside of the device cover.
- Do not handle batteries with metal tools (eg tweezers, etc.). Conductive contact of both battery terminals can cause a short circuit.
- It is recommended that you remove the batteries from the device when not in use. This protects the device from damage from leaking batteries. Should the batteries leak, have the device cleaned by an authorized service center.

Cleaning and maintenance of food contact equipment

- The appliance is designed to come into contact with food. Therefore, before using the appliance for the first time and after each use, clean the appliance and its accessories thoroughly and discard any food residue.
- Clean the machine according to the following instructions:
 - Use only a soft sponge or cloth and liquid cleaners intended for cleaning and washing the kitchenware to clean the covers, parts and accessories of the machine.
- Do not use abrasive cleaning agents such as abrasives. steel wires, cleaning powders etc
Do not use any scrapers or sharp tools.
- Do not use steam cleaners and/or high pressure cleaners as they may damage parts of the machine.
- Apply a small amount of liquid detergent concentrate to the sponge or cloth. Wipe off contaminated parts with adequate pressure but thoroughly to remove all food and fat residues.
- Wipe the cleaned surfaces of the machine and its parts with a soft cloth and, if necessary, wash them with warm water.
- Apply this procedure appropriately, or repeat 2 to 3 times to remove any food and detergent residues.
- At the end, always wipe cleaned and washed surfaces of the device and its parts thoroughly with a soft cloth or paper towel.

Operation

Device description:

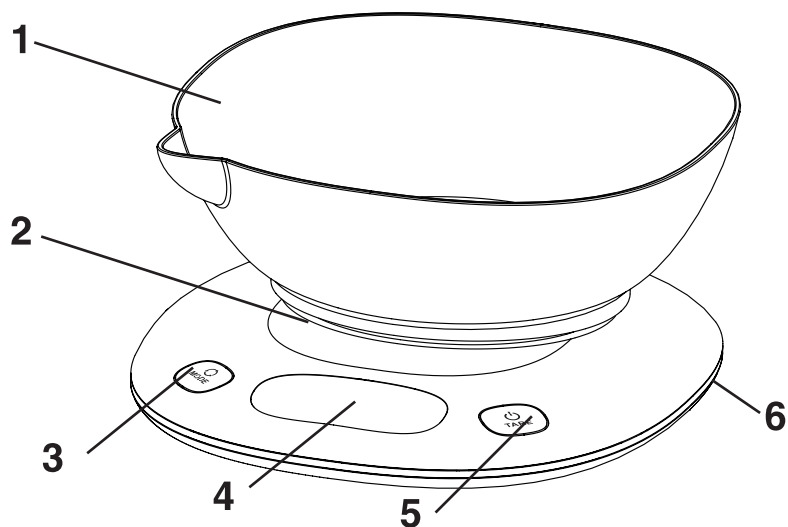

- 1 weighing bowl
- 2 weighing surface
- 3 MODE button (weight and volume units)
- 4 display
- 5 /TARE button (on/off/Tare)
- 6 battery compartment cover (bottom of scale)

Preparation

Power supply

The device works on one 3 V CR2032 battery.

Before using the device, you must insert the battery into the device. Open the battery compartment cover (6) and insert one CR2032 3V battery. Observe the correct polarity + and -. The positive pole must point upwards. Close the battery cover.

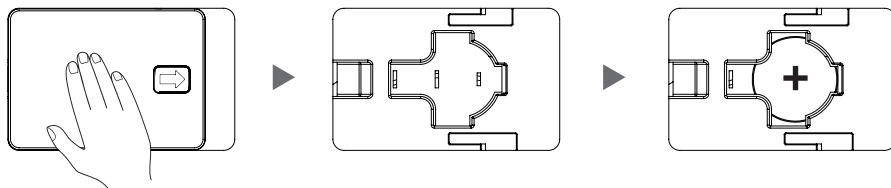

To switch on the scale, touch /TARE with your finger and switch it off by holding your finger for approx. 3 seconds.

Location

Place the device on a flat, firm and hard surface. Do not place it, for example, on the carpet.

Weighing

- 1 Place a bowl or other container on the weighing platform before switching on the device.
- 2 Touch /TARE turn on the scale.
- 3 Wait until the weighing before weighing the display shows 0.
- 4 Press **MODE** to select weighing mode in grams (so that the indicator for weighing units **g** illuminates).
- 5 Place the prepared food on the bowl (their weight will appear on the display).
If the weight of the food exceeds 5,000 g, an **EEEE** error message will appear on the display.

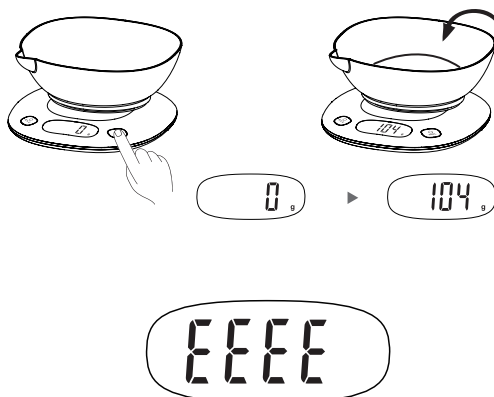

Switching units

The weight is factory set to units of measure g.

If you need to change the units of measure (g, oz, ml, cup), follow these steps:

1. There is a **MODE** switch on the left side of the scale.
2. Press the **MODE** button repeatedly to select the units of measure (g, oz, ml, cup).

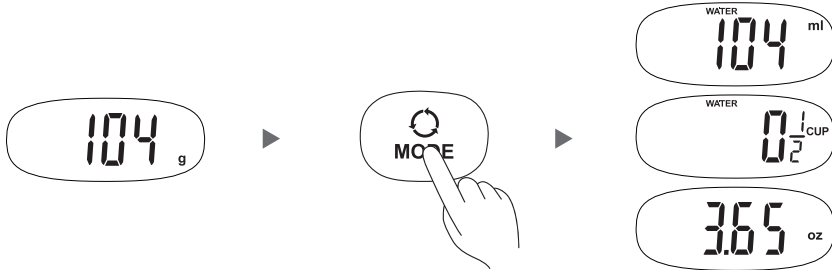

TARE function

If you want to weigh several types of food and do not want to empty the bowl after each weighing, proceed as follows:

After the first weighing, touch the **⏻/TARE** button. The display shows **0g**.

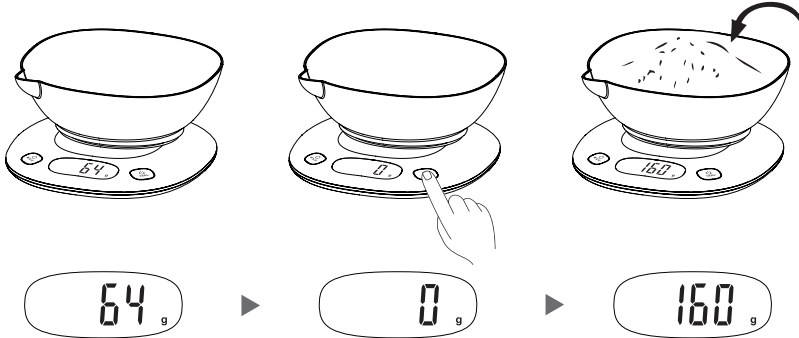

You can add and weigh other foods up to the maximum load capacity of the scale 5 000 g, while you no longer have to remove the weighed food from the bowl (after adding and to weigh more food, always press the **⏻/TARE** button).

Milk/water volume measurement

- 1 Place the device on a flat, firm and hard surface. Do not place it, for example on the carpet.
- 2 Press **⏻/TARE** turn on the scale.
- 3 Wait until **0** appears on the display before measuring.
- 4 Press the **MODE** button to select the water volume measurement mode so that the **ml, cup** (**WATER, MILK**) indicator is lit.
- 5 Place a suitable container for the measuring liquid on the weighing surface. Touch the **⏻/TARE** key to reset the balance and display **0**.
- 6 Pour the liquid to be measured into the container. The display shows the volume of liquid in ml or cup.

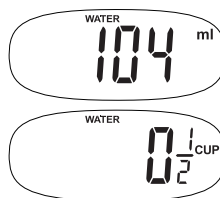

Switching off the scale

Automatic shutdown

If you do not use the scale for a certain time and the display shows zero for a longer time, the scale switches off automatically in approx. 60 seconds.

Manual shutdown

Zariadenie po použití vypnete dotknutím a pridržaním tlačidla **⏻/TARE**.
Displej zhasne.

Warning indicators

- 1 If the weight of the food exceeds 5,000 g, an **EEEE** error message will appear on the display. The maximum load capacity of 5 000 g has been exceeded. Dispose of the weighed food immediately to prevent damage to the scale.
- 2 Low batteries - the **Lo** symbol lights up on the display. The batteries need to be replaced with new ones.
- 3 The balance is not stable before weighing (located on a unstable surface), the display shows the error message **unSt**.
Place the scale in a stable place.

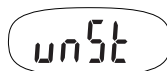
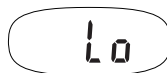

Battery replacement and disposal

If Lo appears on the display, the batteries need to be replaced.

You can ensure the ecological disposal of used batteries by handing them over to your specialized dealer, or throw them in in special containers prepared for this purpose by the municipality. Find out how to dispose of batteries according to local regulations and standards.

Do not dispose of them in unsorted municipal waste.

If you do not plan to use the device for a long time, remove the batteries. This will prevent them from discharging and possible damage to the device by leaking electrolyte.

Cleaning and maintenance

Clean the scale with a dry cloth slightly moistened with water only. Do not use harsh cleaners or solvents such as alcohol, benzine, or thinner to clean.

Do not immerse the scale in water.

Clean all plastic parts immediately after weighing fatty foods, spices, strongly flavored and colored foods. Avoid contact of the scale with acidic foods (citrus juices, etc.).

Warning!

If the display shows an **EEEE** message permanently, or if the scale does not work even though you have replaced the batteries, contact the manufacturer or an authorized service center.

Technical specifications

Power supply:	DC 3 V from the battery (1x 3 V CR2032)
Units of measure:	g, oz, ml, cup
Maximum weighed weight:	5 000 g
Scale dimensions (W x H x D):	18 x 21 x 3.5 cm (without bowl)
Weight:	0,3 kg (without battery / bowl)

We reserve the right to make changes!

Producer:

ORAVA retail 1, a.s.
Seberíniho 2
821 03 Bratislava
Slovenská republika

Importer:

ORAVA retail 1, a.s.
Seberíniho 2
821 03 Bratislava
Slovenská republika

ORAVA distribution CZ, s.r.o.
Ostravská 494
739 25 Sviadnov
Česká republika

**DISPOSAL OF USED ELECTRICAL AND ELECTRONIC EQUIPMENT**

The symbol on the product or on its packaging indicates that this product does not belong to household waste. It is necessary to take it to a collection point for electrical recycling and electronic equipment.

By ensuring proper disposal of this product, you will help prevent negative consequences to the environment and human health that would otherwise be caused by inappropriate disposal of this product. For more detailed information about recycling of this product, please contact your local authority, your household waste disposal service or the shop where you purchased the product.



This product meets all the essential requirements of the EU directives that apply to it.